

Sec. 27 Sec. 26  
Sec. 34 Sec. 35

Sec. 26  
Sec. 35 1/4 Cor.

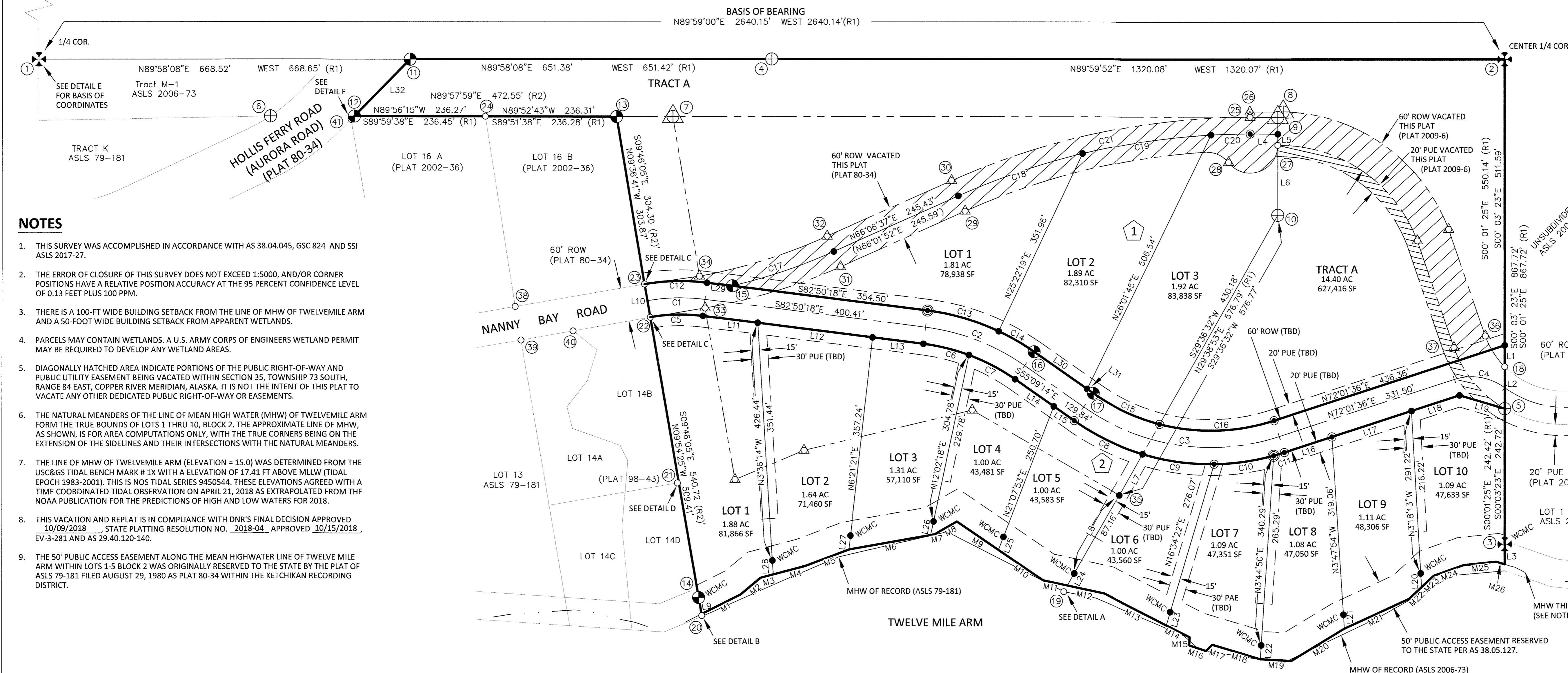
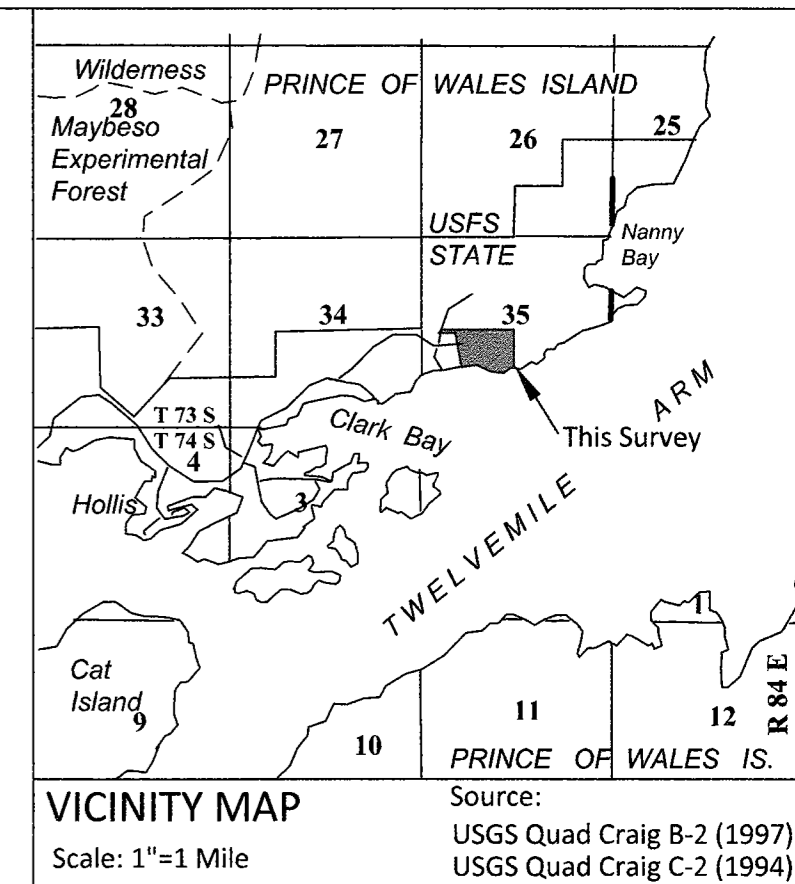

- NOTES**
- THIS SURVEY WAS ACCOMPLISHED IN ACCORDANCE WITH AS 38.04.045, GSC 824 AND SSI ASLS 2017-27.
  - THE ERROR OF CLOSURE OF THIS SURVEY DOES NOT EXCEED 1:5000, AND/OR CORNER POSITIONS HAVE A RELATIVE POSITION ACCURACY AT THE 95 PERCENT CONFIDENCE LEVEL OF 0.13 FEET PLUS 100 PPM.
  - THERE IS A 100-FT WIDE BUILDING SETBACK FROM THE LINE OF MHW OF TWELVEMILE ARM AND A 50-FOOT WIDE BUILDING SETBACK FROM APPARENT WETLANDS.
  - PARCELS MAY CONTAIN WETLANDS. A U.S. ARMY CORPS OF ENGINEERS WETLAND PERMIT MAY BE REQUIRED TO DEVELOP ANY WETLAND AREAS.
  - DIAGONALLY HATCHED AREA INDICATE PORTIONS OF THE PUBLIC RIGHT-OF-WAY AND PUBLIC UTILITY EASEMENT BEING VACATED WITHIN SECTION 35, TOWNSHIP 73 SOUTH, RANGE 84 EAST, COPPER RIVER MERIDIAN, ALASKA. IT IS NOT THE INTENT OF THIS PLAT TO VACATE ANY OTHER DEDICATED PUBLIC RIGHT-OF-WAY OR EASEMENTS.
  - THE NATURAL MEANDERS OF THE LINE OF MEAN HIGH WATER (MHW) OF TWELVEMILE ARM FORM THE TRUE BOUNDS OF LOTS 1 THRU 10, BLOCK 2. THE APPROXIMATE LINE OF MHW, AS SHOWN, IS FOR AREA COMPUTATIONS ONLY, WITH THE TRUE CORNERS BEING ON THE EXTENSION OF THE SIDELINES AND THEIR INTERSECTIONS WITH THE NATURAL MEANDERS.
  - THE LINE OF MHW OF TWELVEMILE ARM (ELEVATION - 15.0) WAS DETERMINED FROM THE USCGS TIDAL BENCH MARK # 1X WITH A ELEVATION OF 17.41 FT ABOVE MLLW (TIDAL EPOCH 1983-2001). THIS IS NOS TIDAL SERIES 9450544. THESE ELEVATIONS AGREED WITH A TIME COORDINATED TIDAL OBSERVATION ON APRIL 21, 2018 AS EXTRAPOLATED FROM THE NOAA PUBLICATION FOR THE PREDICTIONS OF HIGH AND LOW WATERS FOR 2018.
  - THIS VACATION AND REPLAT IS IN COMPLIANCE WITH DNR'S FINAL DECISION APPROVED 10/09/2018, STATE PLATTING RESOLUTION NO. 2018-04, APPROVED 10/15/2018, EV-3-281 AND AS 29.40.120-140.
  - THE 50' PUBLIC ACCESS EASEMENT ALONG THE MEAN HIGHWATER LINE OF TWELVE MILE ARM WITHIN LOTS 1-5 BLOCK 2 WAS ORIGINALLY RESERVED TO THE STATE BY THE PLAT OF ASLS 79-181 FILED AUGUST 29, 1980 AS PLAT 80-34 WITHIN THE KETCHIKAN RECORDING DISTRICT.

VICINITY MAP  
Scale: 1"=1 Mile  
Source: USGS Quad Craig B-2 (1997) USGS Quad Craig C-2 (1994)

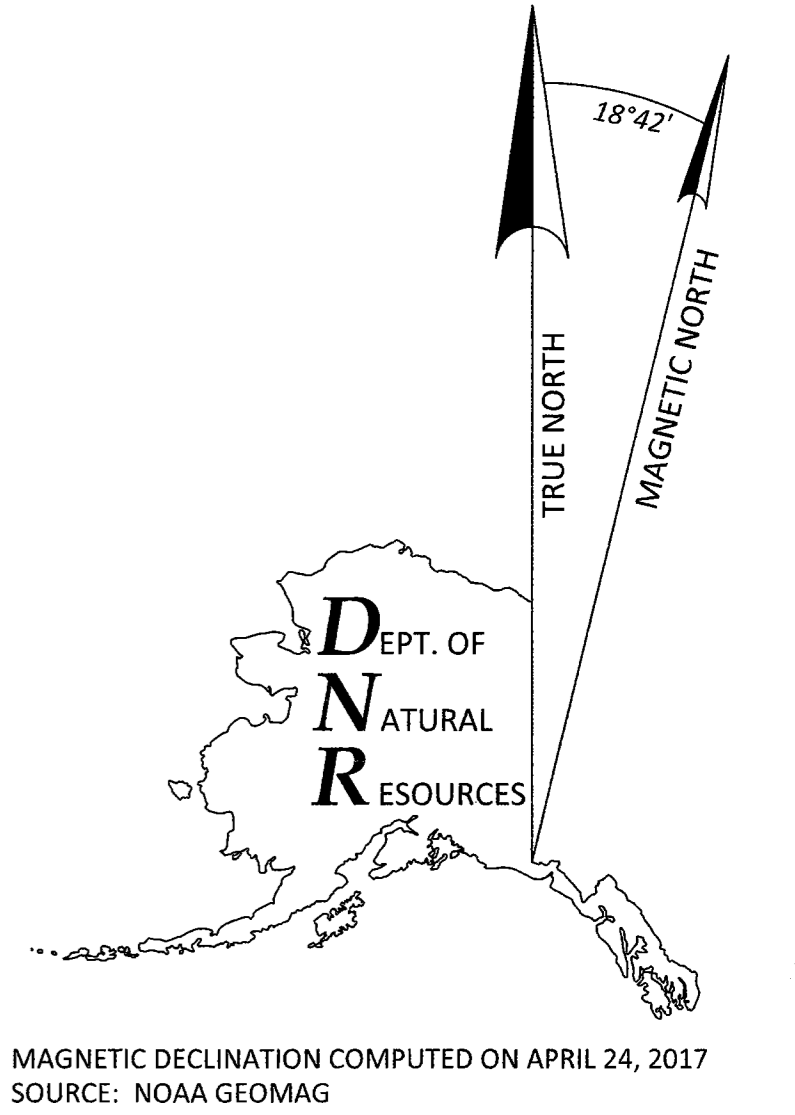

**SCALE 1"=100'**  
THIS DRAWING MAY BE REDUCED, VERIFY SCALE BEFORE USING

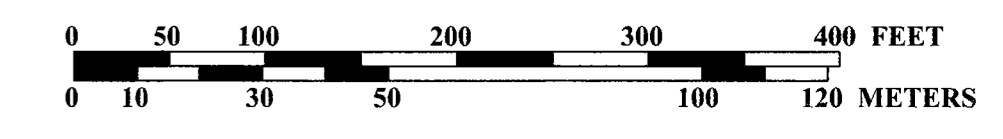

1 METER=3.2808333 U.S. SURVEY FEET  
1 U.S. ACRE=0.4047 HECTARES

SHEET 1 OF 3  
DATE OF SURVEY: BEGINNING: 12/05/2017 ENDING: 09/14/2018  
SURVEYOR: R&M ENGINEERING-KETCHIKAN, INC. 7180 REVILLA ROAD, SUITE 300 KETCHIKAN, ALASKA 99901 PHONE # 907-225-7917 COAH 576

STATE OF ALASKA  
DEPARTMENT OF NATURAL RESOURCES  
DIVISION OF MINING, LAND & WATER AND  
ALASKA MENTAL HEALTH TRUST AUTHORITY  
ANCHORAGE, ALASKA

**ALASKA STATE LAND SURVEY No. 2017-27**

Clark Bay View Subdivision, Phase I

A SUBDIVISION AND REPLAT OF  
TRACT D PARCELS 1 & 2, TRACTS G & H,  
ALASKA STATE LAND SURVEY No. 79-181 (PLAT 80-34) AND  
TRACTS M-2 & M-3, ALASKA STATE LAND SURVEY No. 2006-73 (PLAT 2009-6)  
AND  
PUBLIC RIGHT-OF-WAY AND UTILITY EASEMENT VACATIONS  
CREATING  
LOTS 1-3, BLOCK 1; LOTS 1-10, BLOCK 2 AND TRACT A  
CONTAINING 34.50 ACRES MORE OR LESS

LOCATED WITHIN  
PARTIALLY SURVEYED SECTION 35, TOWNSHIP 73 SOUTH, RANGE 84 EAST  
COPPER RIVER MERIDIAN, ALASKA  
KETCHIKAN RECORDING DISTRICT

DRAWN BY: MCH  
DATE: APRIL 8, 2019  
SCALE: 1"=100'  
APPROVAL RECOMMENDED  
for Paul J. Hunkler 5/22/2019  
STATEWIDE PLATTING SUPERVISOR  
CHECKED: CGP  
FILE NO: ASLS 20170027 // EV-3-281  
TLS 2019-01



| LINE | DIRECTION                       | LENGTH (FT)     |
|------|---------------------------------|-----------------|
| L1   | S 00°03'23" E                   | 38.15           |
| L2   | S 00°03'23" E                   | 75.27           |
| L3   | S 00°03'23" E (S00°01'25" E R1) | WD=36.00(47.64) |
| L4   | S 89°31'58" E                   | 50.02           |
| L5   | S 00°12'22" E (N00°01'24" W R1) | 19.93           |
| L6   | S 00°02'25" E (S00°00'16" E R1) | 125.13(125.05)  |
| L7   | S 29°36'32" W (N29°38'53" E R1) | 84.73(576.79)   |
| L8   | S 29°53'46" W (N29°38'53" E R1) | 162.16(199.49)  |
| L9   | N 09°54'25" W                   | WD=30.00        |
| L10  | N 09°53'36" W                   | 60.00           |
| L11  | S 82°50'18" E                   | 99.39           |
| L12  | S 82°50'18" E                   | 208.62          |
| L13  | S 82°50'18" E                   | 92.39           |
| L14  | S 55°09'14" E                   | 84.84           |
| L15  | S 55°09'14" E                   | 45.00           |
| L16  | N 72°01'36" E                   | 90.00           |
| L17  | N 72°01'36" E                   | 150.65          |
| L18  | N 72°01'36" E                   | 90.85           |
| L19  | S 73°34'00" E                   | 84.80           |
| L20  | N 03°18'13" W                   | WD=25.00        |
| L21  | N 03°47'54" W                   | WD=25.00        |
| L22  | N 03°44'50" W                   | WD=25.00        |
| L23  | N 16°34'22" E                   | WD=25.00        |
| L24  | S 29°53'46" W (N29°38'53" E R1) | WD=25.00        |
| L25  | N 21°07'53" E                   | WD=25.00        |
| L26  | N 12°02'18" E                   | WD=25.00        |
| L27  | N 06°21'21" E                   | WD=25.00        |
| L28  | N 03°36'14" W                   | WD=25.00        |
| L29  | S 82°50'18" E                   | 45.90           |
| L30  | S 55°09'14" E                   | 116.40          |
| L31  | S 55°09'14" E                   | 13.44           |
| L32  | N 44°37'10" E (N44°38'10" E R1) | 143.02(143.09)  |

| CURVE | DELTA     | RADIUS   | ARC     | CHORD   | CH. BEARING   |
|-------|-----------|----------|---------|---------|---------------|
| C1    | 17°01'45" | 350.00'  | 104.03' | 103.64' | N 88°38'49" E |
| C2    | 27°41'04" | 400.00'  | 193.27' | 191.40' | S 68°59'46" E |
| C3    | 52°49'11" | 400.00'  | 368.75' | 355.83' | S 81°33'49" E |
| C4    | 54°37'43" | 100.00'  | 95.35'  | 91.77'  | S 80°39'33" E |
| C5    | 17°01'36" | 320.00'  | 95.10'  | 94.75'  | N 88°38'54" E |
| C6    | 13°06'35" | 370.00'  | 84.66'  | 84.47'  | S 76°17'01" E |
| C7    | 14°34'30" | 370.00'  | 94.12'  | 93.87'  | S 62°26'28" E |
| C8    | 18°15'15" | 430.00'  | 137.00' | 136.42' | S 64°16'51" E |
| C9    | 17°23'33" | 430.00'  | 130.53' | 130.03' | S 82°06'15" E |
| C10   | 14°30'29" | 430.00'  | 108.88' | 108.59' | N 81°56'44" E |
| C11   | 02°39'54" | 430.00'  | 20.00'  | 20.00'  | N 73°21'33" E |
| C12   | 17°01'52" | 380.00'  | 112.96' | 112.54' | N 88°38'46" E |
| C13   | 17°50'42" | 430.00'  | 133.93' | 133.38' | S 73°54'57" E |
| C14   | 09°50'22" | 430.00'  | 73.85'  | 73.75'  | S 60°04'25" E |
| C15   | 20°24'43" | 370.00'  | 131.81' | 131.12' | S 65°21'35" E |
| C16   | 32°24'28" | 370.00'  | 209.28' | 206.50' | N 88°13'49" E |
| C17   | 11°02'46" | 1000.00' | 192.79' | 192.49' | N 71°22'31" E |
| C18   | 10°28'41" | 1294.74' | 236.78' | 236.45' | N 71°15'08" E |
| C19   | 10°20'32" | 1294.74' | 233.71' | 233.39' | N 81°39'44" E |
| C20   | 03°07'12" | 1294.74' | 70.50'  | 70.49'  | N 88°23'36" E |
| C21   | 23°56'24" | 1294.74' | 540.99' | 537.06' | N 77°58'59" E |

| LINE | DIRECTION     | LENGTH (FT) |
|------|---------------|-------------|
| M1   | N 63°29'41" E | 78.41       |
| M2   | N 50°09'45" E | 46.58       |
| M3   | N 75°17'32" E | 23.71       |
| M4   | N 75°17'32" E | 58.83       |
| M5   | N 69°29'21" E | 84.78       |
| M6   | N 80°03'19" E | 149.52      |
| M7   | N 80°03'19" E | 7.00        |
| M8   | N 60°06'40" E | 46.37       |
| M9   | S 55°54'19" E | 90.73       |
| M10  | S 55°54'19" E | 97.00       |
| M11  | S 78°00'23" E | 68.23       |
| M12  | S 78°00'23" E | 44.73       |
| M13  | S 63°09'54" E | 124.77      |
| M14  | S 63°09'54" E | 47.23       |
| M15  | S 4°00'07" W  | 14.50       |
| M16  | S 71°19'06" E | 31.96       |
| M17  | N 45°46'00" E | 15.91       |
| M18  | N 73°25'25" E | 90.48       |
| M19  | S 86°49'37" E | 55.86       |
| M20  | N 58°51'43" E | 111.77      |
| M21  | N 65°20'43" E | 128.00      |
| M22  | N 47°14'54" E | 30.50       |
| M23  | N 47°14'54" E | 30.50       |
| M24  | N 70°21'25" E | 56.37       |
| M25  | N 84°08'39" E | 59.13       |
| M26  | S 73°16'48" E | 16.19       |

| LEGEND |  |
|--------|--|
|        | FOUND BLM/GLO MONUMENT - 3/4" DIA. BRASS CAP ON 2" IRON PIPE UNLESS OTHERWISE NOTED                      |
|        | BLM/GLO MONUMENT OF RECORD   |
|        | SET PRIMARY MONUMENT - 3/4" DIA. ALUM. CAP ON 30" LONG 2 1/2" DIA. ALUM POST WITH MAGNET                 |
|        | FOUND PRIMARY MONUMENT - 3/4" DIA. ALUM. CAP ON 2 1/2" DIA. ALUM POST WITH MAGNET UNLESS OTHERWISE NOTED |
|        | SECONDARY MONUMENT SET THIS SURVEY   |
|        | SECONDARY MONUMENT SET THIS SURVEY WITH 20" - 26" LONG REBAR DUE TO SHALLOW BEDROCK                      |
|        | SECONDARY MONUMENT SET IN CONCRETE THIS SURVEY   |
|        | SECONDARY MONUMENT RECOVERED   |
|        | SECONDARY MONUMENT REMOVED THIS SURVEY   |
|        | PRIMARY MONUMENT REMOVED THIS SURVEY   |
|        | UNSURVEYED   |
|        | SURVEYED   |
|        | RECORD BOUNDARY LINE VACATED THIS PLAT   |
|        | PUBLIC ACCESS EASEMENT   |
|        | TO BE DEDICATED TO THE PUBLIC BY THIS PLAT   |
|        | MEAN HIGH WATER  |
|        | RECORD PER PLAT NO. 2009-6 (ASLS 2006-73)  |
|        | RECORD PER PLAT NO. 80-34 (ASLS 79-181)  |
|        | BLC ER   |
|        | PUBLIC RIGHT-OF-WAY (ROW) VACATED THIS PLAT  |
|        | PUBLIC UTILITY EASEMENT (PUE) VACATED THIS PLAT  |

| TIDAL DATUM            |       |
|------------------------|-------|
| SEE NOTE 7             |       |
| NOAA CHART 17426       |       |
| HOLLIS ANCHORAGE       |       |
| (55°28' N / 132°39' W) |       |
| MHHW                   | 15.9' |
| MHW                    | 15.0' |
| MLW                    | 1.6'  |
| MLLW                   | 0.0'  |

**BASIS OF BEARING**  
BEARINGS SHOWN ARE NAD 83 GEODETIC BEARINGS BASED ON HIGH PRECISION GLOBAL NAVIGATION SATELLITE SYSTEM TECHNOLOGY, USING TRIMBLE (R8-3 & R10) RECEIVERS, DIFFERENTIALLY CORRECTED AND PROCESSED USING TRIMBLE BUSINESS CENTER SOFTWARE. DISTANCES SHOWN ARE REDUCED TO HORIZONTAL FIELD DISTANCES.

**COORDINATES**  
THE SHOWN NAD 83 COORDINATES ARE BASED ON AN OPUS SOLUTION (2011)(EPOCH:2010.0000) FOR HPC-2 AS SHOWN ON THE RECORD PLAT FOR A.S.L.S. 79-181. THE COORDINATES WERE CONSTRAINED TO THE NATIONAL SPATIAL REFERENCE SYSTEM USING THE CORS REFERENCE STATIONS: AB49 (PID M07451), A155 (DK6482), AND LEV6 (PID DJ3035).

Ketchikan Recording District Plat # 2017-24

**BLM MONUMENTS RECOVERED**

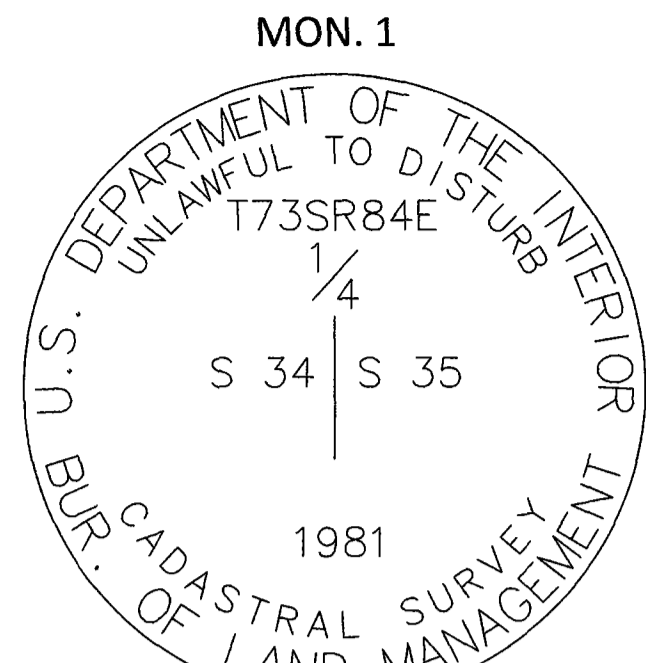

RECOVERED 2.5" DIA. POST MON. WITH 3.25" DIA. BRASS CAP PROJECTING 6" ABOVE A MOUND OF STONE. IN GOOD CONDITION

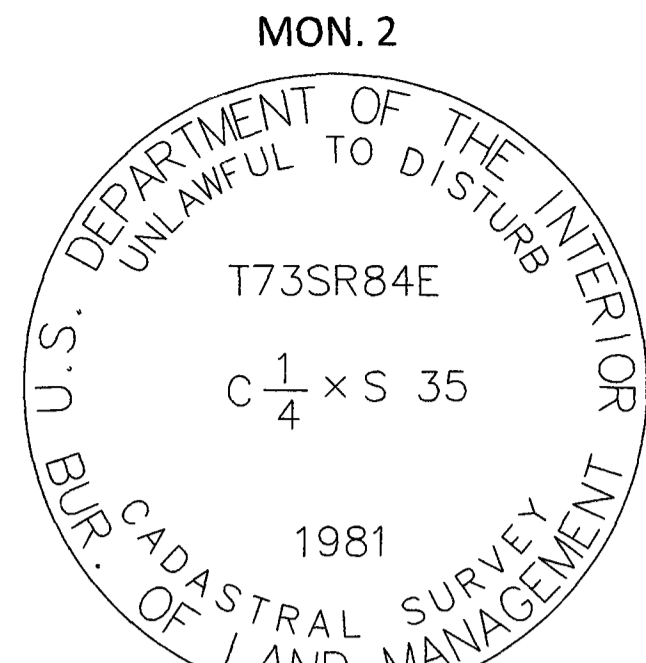

RECOVERED 2.5" DIA. POST MON. WITH 3.25" DIA. BRASS CAP PROJECTING 3" ABOVE A MOUND OF STONE. IN GOOD CONDITION

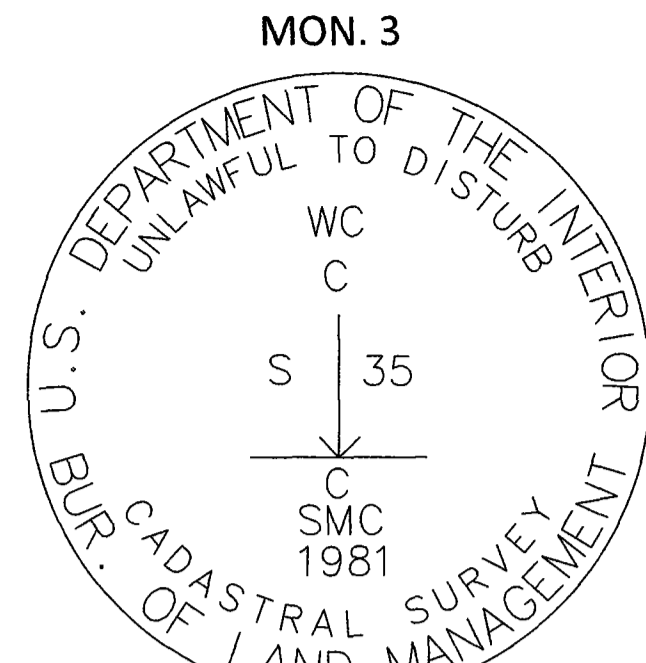

RECOVERED 2.5" DIA. POST MON. WITH 3.25" DIA. BRASS CAP PROJECTING 3" ABOVE A MOUND OF STONE. IN GOOD CONDITION

| CORNER ACCESSORY (C.A.) DATA |      |               |           |                     |
|------------------------------|------|---------------|-----------|---------------------|
| MON                          | C.A. | DIRECTION     | DIST (FT) | DESCRIPTION         |
| 1                            | 1    | N 17° E       | 24.1'     | 19" HEMLOCK         |
| 1                            | 2    | S 82° E       | 19.4'     | 7" HEMLOCK          |
| 2                            | 1    | N 22°10' E    | 96.1'     | 20" HEMLOCK         |
| 2                            | 2    | S 78° E       | 10.5'     | 7" CEDAR            |
| 3                            | 1    | N 15° E       | 13.5'     | 6" CEDAR            |
| 3                            | 1    | S 51°09' W    | 20.1'     | 11" HEMLOCK         |
| 3                            | 2    | S 13°12' E    | 45.6'     | 24" SPRUCE          |
| 3                            | 3    | N 72°31' E    | 3.9'      | TRIANGLE MARKER     |
| 6                            | 1    | S 13°15'54" W | 14.08"    | REBAR & PLASTIC CAP |
| 6                            | 2    | S 77°00'56" E | 11.83"    | REBAR & PLASTIC CAP |
| 7                            | 1    |               |           | NOT FOUND           |
| 7                            | 2    |               |           | NOT FOUND           |
| 7                            | 3    |               |           | NOT FOUND           |
| 9                            | 1    | S 52°51' E    | 14.0'     | 8" HEMLOCK          |
| 9                            | 2    | S 71°21' W    | 12.6'     | 10" HEMLOCK         |
| 9                            | 3    | N 51°42' E    | 16.0'     | 26" CEDAR           |
| 10                           | 1    | N 71°14' E    | 13.8'     | 24" HEMLOCK         |
| 10                           | 2    | S 64°29' E    | 20.0'     | 10" HEMLOCK         |
| 10                           | 3    | S 85° W       | 14.5'     | 24" CEDAR           |

NOTE: BEARING & DISTANCES LISTED WERE MEASURED FROM THE CORNER ACCESSORY TO THE MONUMENT

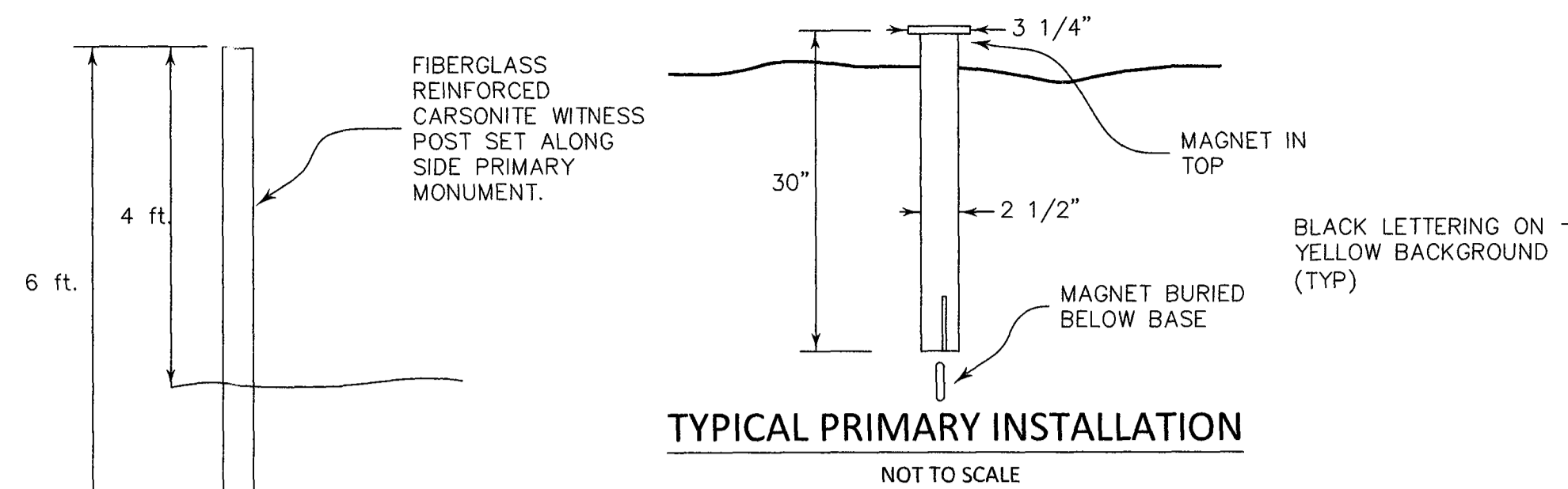

STATE OF ALASKA  
DEPT OF NATURAL RESOURCES  
DIVISION OF LANDS

# BEARING TREE

CORNER IS APPROXIMATELY

DIRECTION:  DISTANCE:

T:  R:  SEC:

CORNER:  TRACT:

POSTED BY:  DATE:

TYPICAL BEARING TREE TAG  
NOT TO SCALE

**STATE OF ALASKA MONUMENTS RECOVERED (PLAT 80-34 AND PLAT 2009-6)**

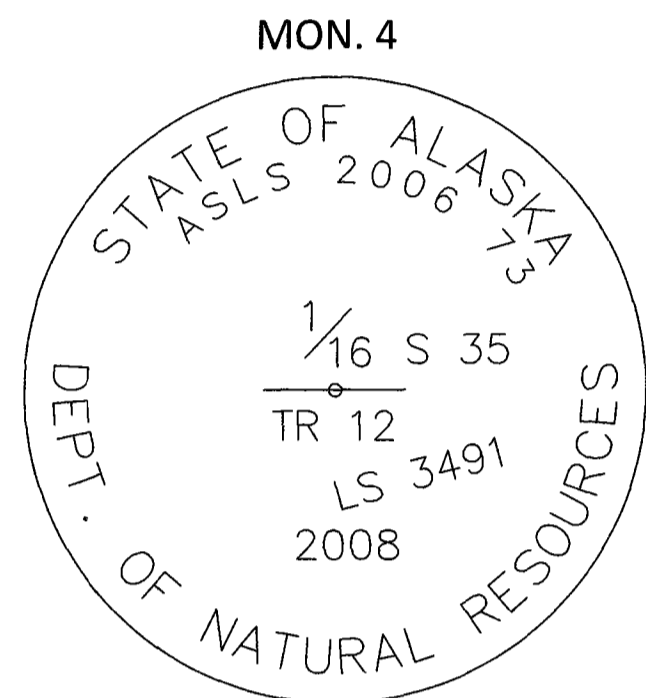

RECOVERED 2.5" DIA. X 30" ALUM POST MON. WITH 3.25" DIA. ALUM. CAP. IN GOOD CONDITION

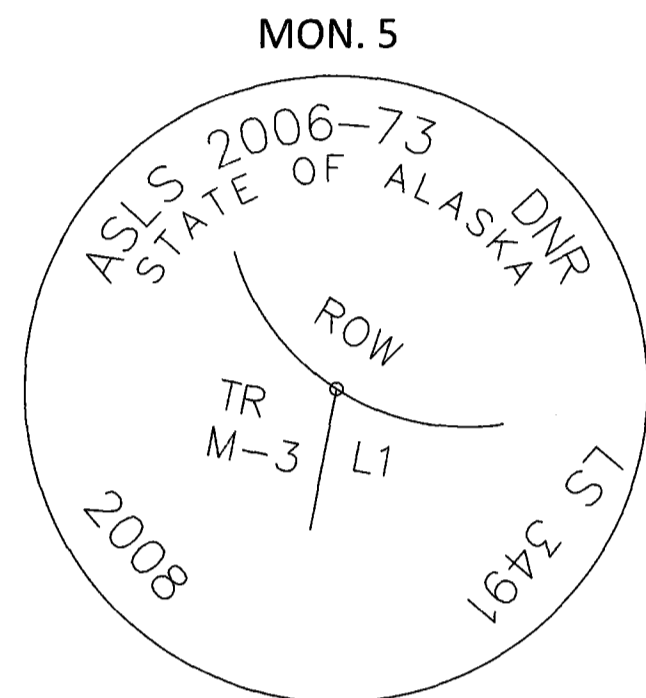

RECOVERED 3.25" ALUM MON. ON 5/8" REBAR WITH RED PLASTIC INSERT. IN GOOD CONDITION

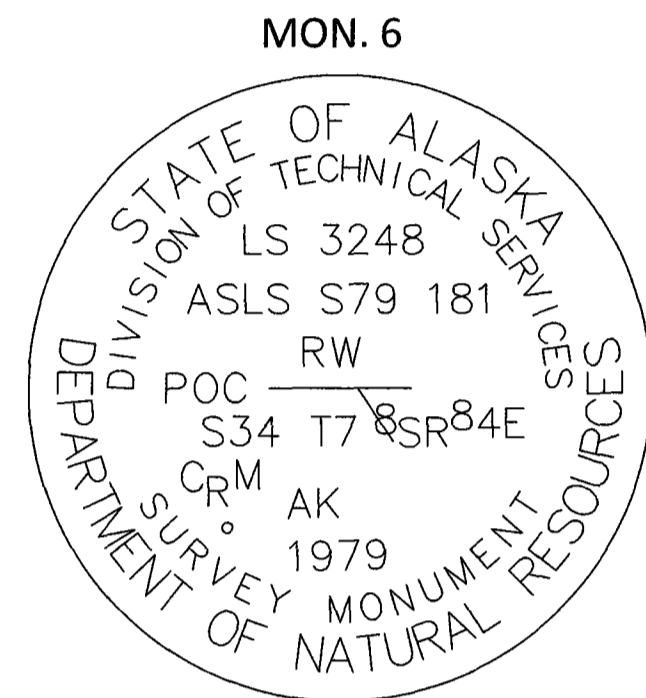

RECOVERED 2.5" DIA. X 30" ALUM POST MON. WITH 3.25" DIA. ALUM. CAP. IN GOOD CONDITION

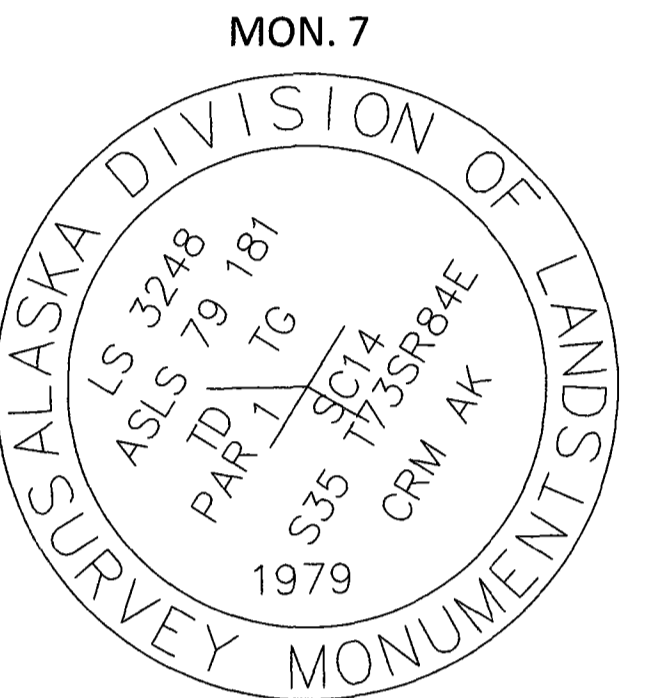

RECOVERED 2.5" DIA. X 30" ALUM POST MON. WITH 3.25" DIA. ALUM. CAP. IN GOOD CONDITION

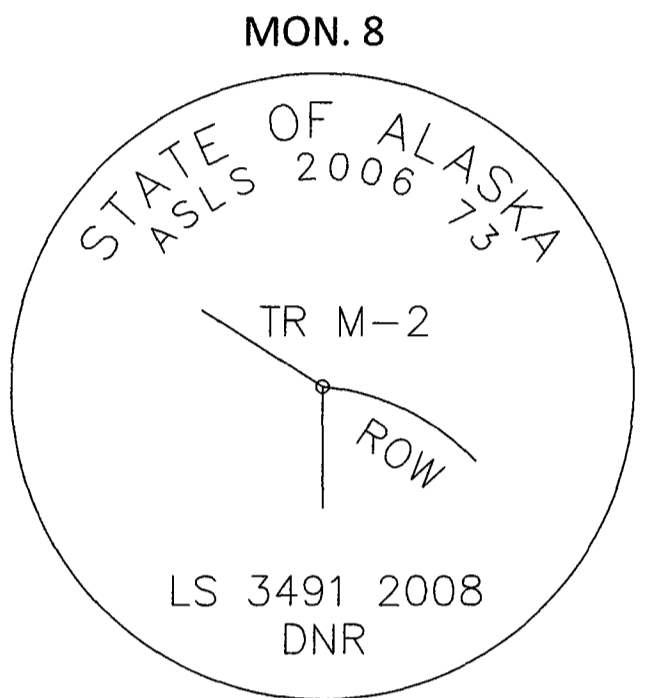

RECOVERED 2.5" DIA. X 30" ALUM POST MON. WITH 3.25" DIA. ALUM. CAP. IN GOOD CONDITION

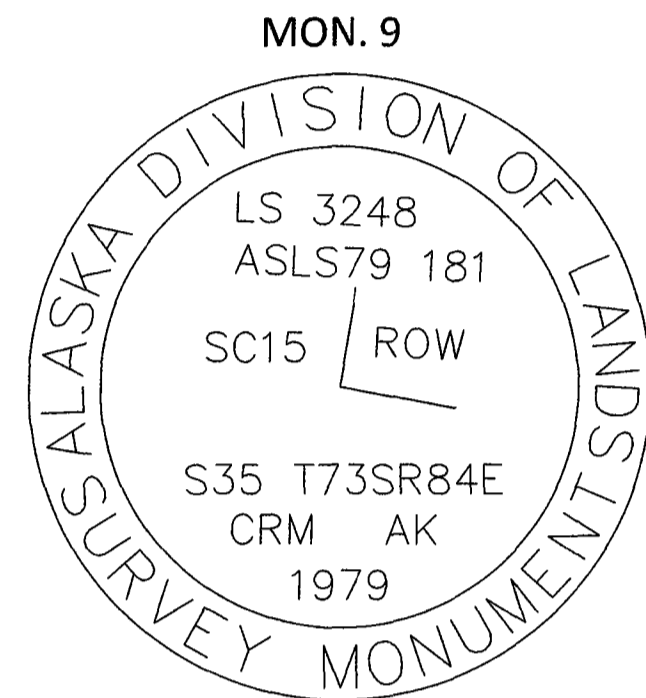

RECOVERED 2.5" DIA. X 30" ALUM POST MON. WITH 3.25" DIA. ALUM. CAP. IN GOOD CONDITION

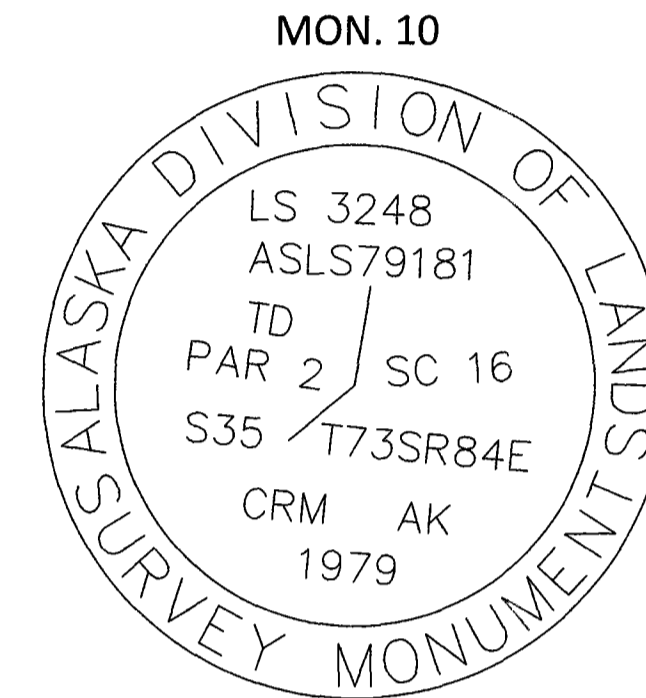

RECOVERED 2.5" DIA. X 30" ALUM POST MON. WITH 3.25" DIA. ALUM. CAP. IN GOOD CONDITION

**SECONDARY MONUMENTS RECOVERED**

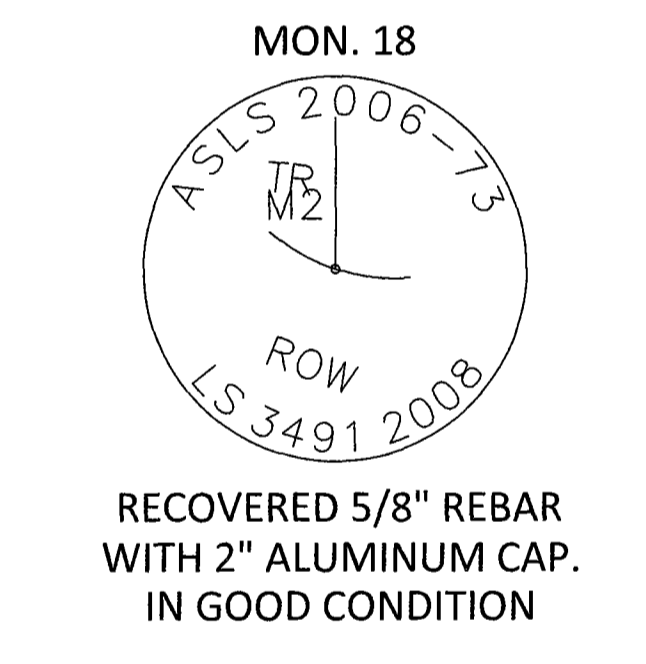

RECOVERED 5/8" REBAR WITH 2" ALUMINUM CAP. IN GOOD CONDITION

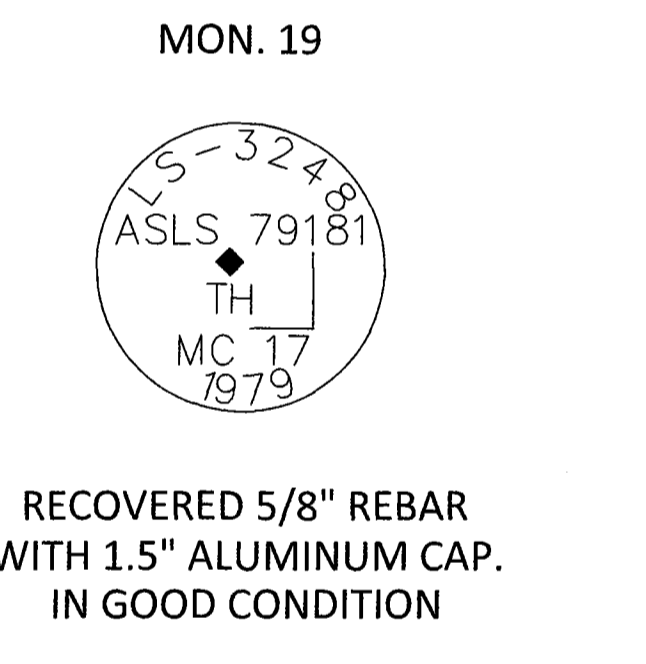

RECOVERED 5/8" REBAR WITH 1.5" ALUMINUM CAP. IN GOOD CONDITION

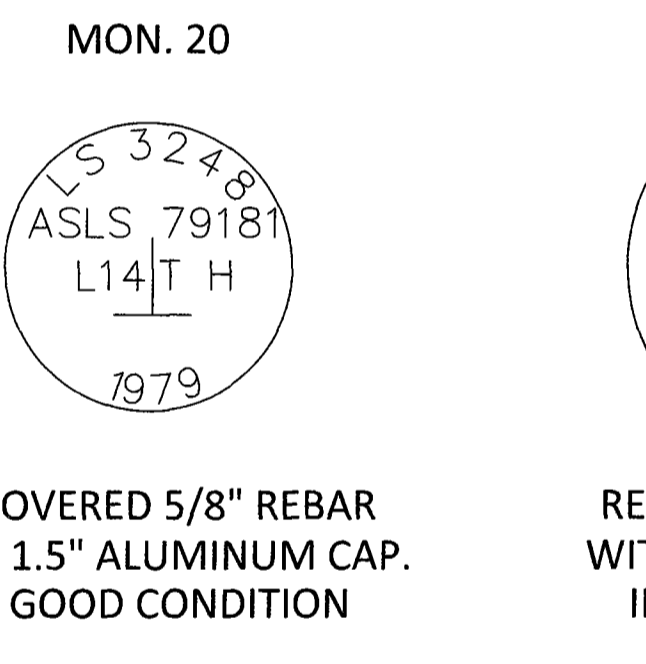

RECOVERED 5/8" REBAR WITH 1.5" ALUMINUM CAP. IN GOOD CONDITION

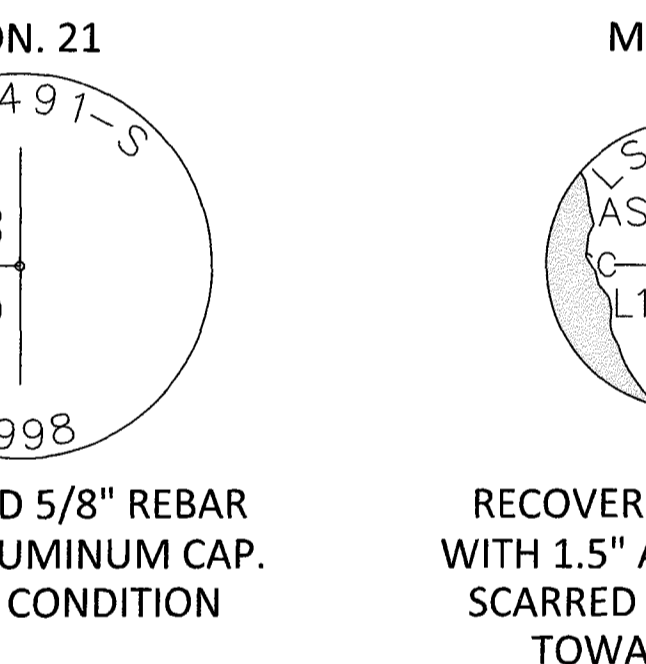

RECOVERED 5/8" REBAR WITH 2" ALUMINUM CAP. IN GOOD CONDITION

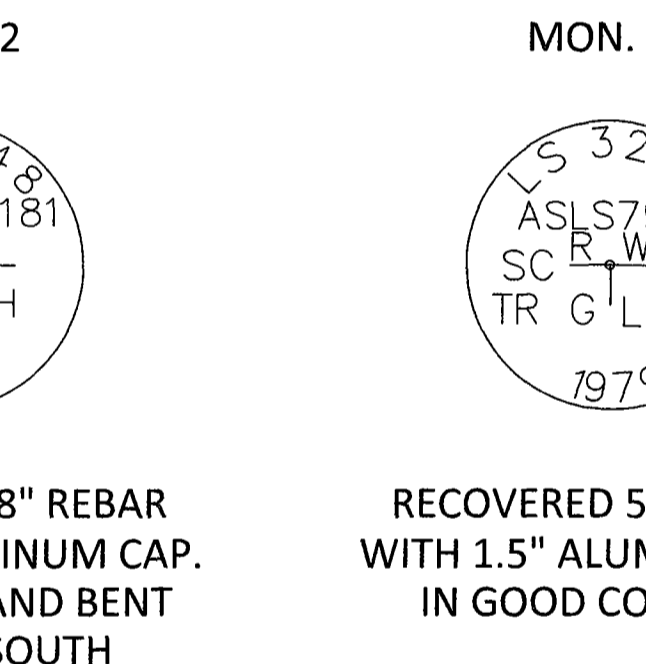

RECOVERED 5/8" REBAR WITH 1.5" ALUMINUM CAP. SCARRED CAP AND BENT TOWARDS SOUTH

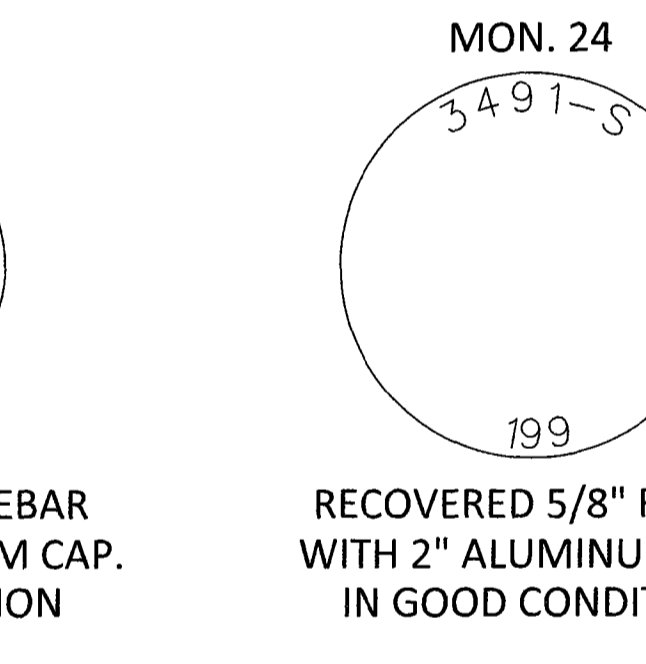

RECOVERED 5/8" REBAR WITH 1.5" ALUMINUM CAP. IN GOOD CONDITION

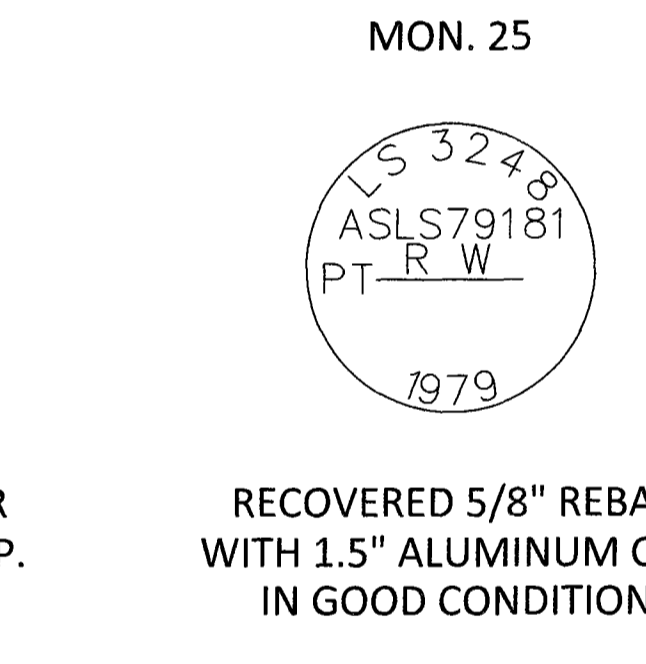

RECOVERED 5/8" REBAR WITH 2" ALUMINUM CAP. IN GOOD CONDITION

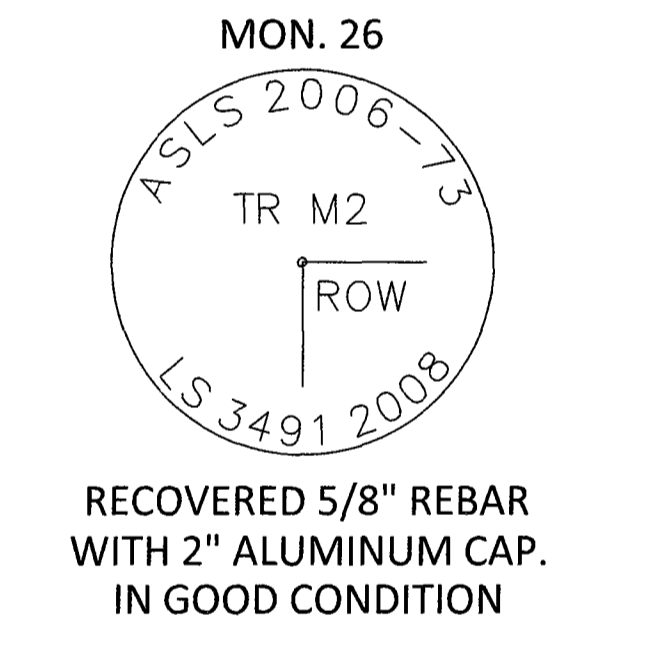

RECOVERED 5/8" REBAR WITH 1.5" ALUMINUM CAP. IN GOOD CONDITION

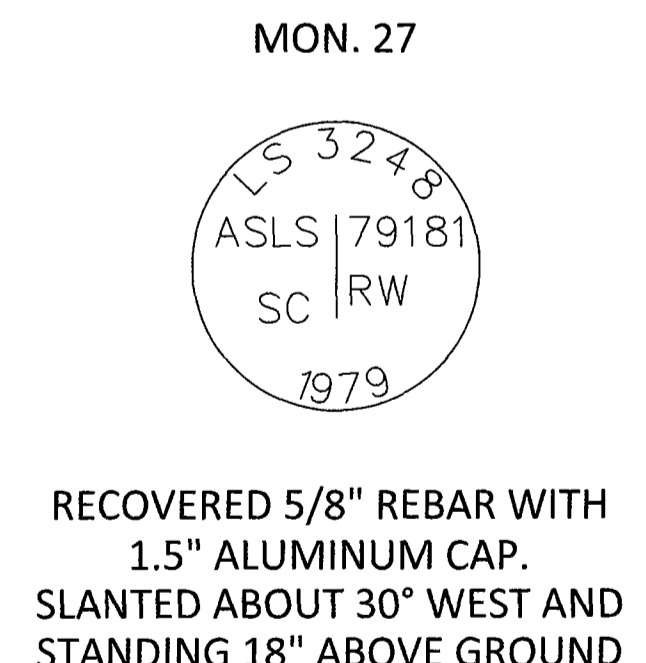

RECOVERED 5/8" REBAR WITH 1.5" ALUMINUM CAP. SLANTED ABOUT 30° WEST AND STANDING 18" ABOVE GROUND

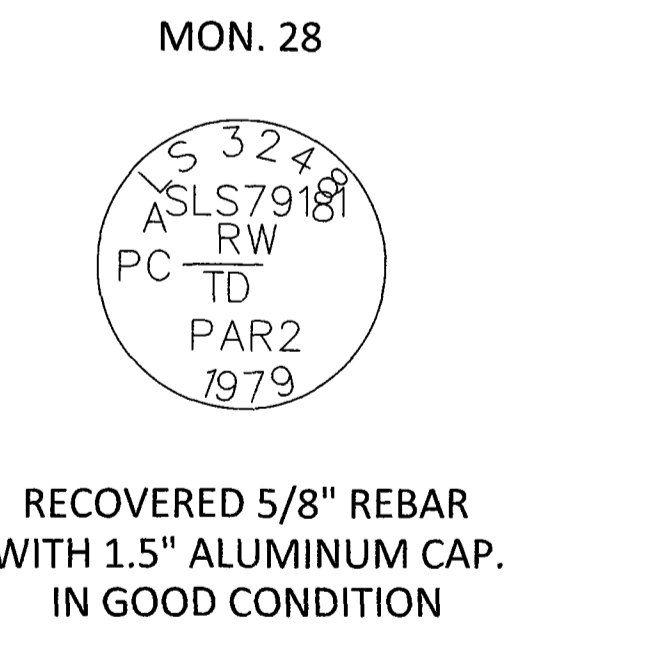

RECOVERED 5/8" REBAR WITH 1.5" ALUMINUM CAP. IN GOOD CONDITION

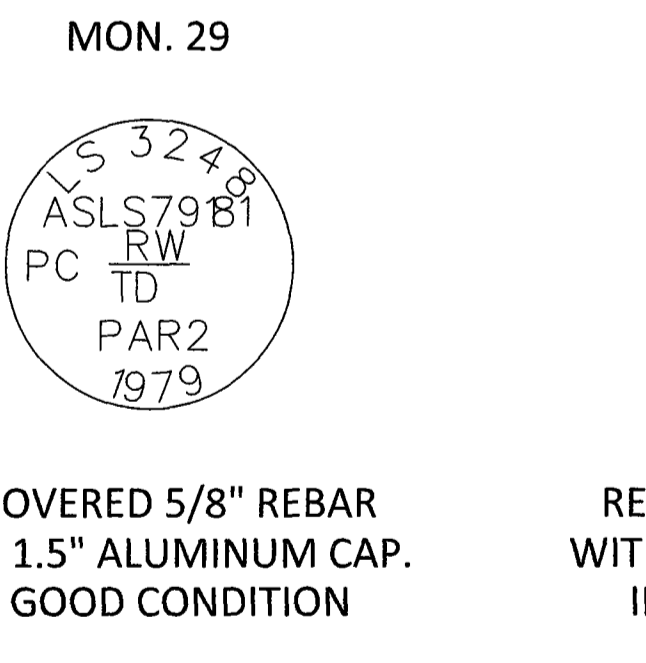

RECOVERED 5/8" REBAR WITH 1.5" ALUMINUM CAP. IN GOOD CONDITION

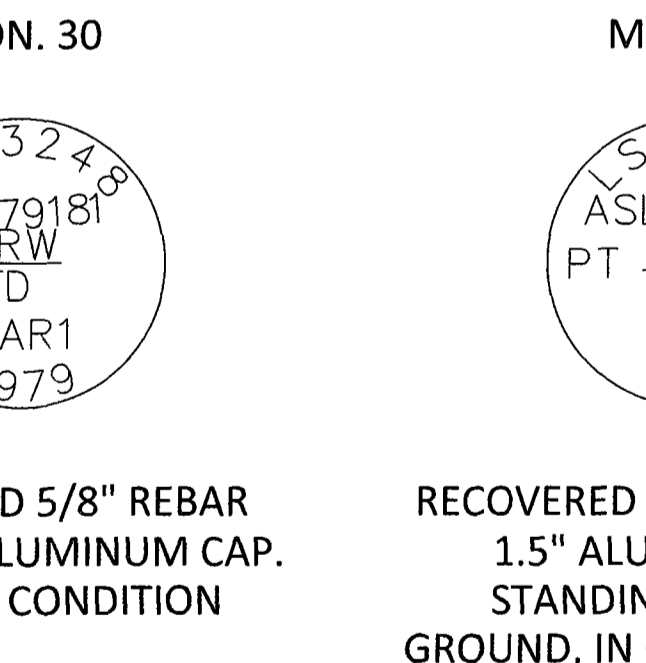

RECOVERED 5/8" REBAR WITH 1.5" ALUMINUM CAP. IN GOOD CONDITION

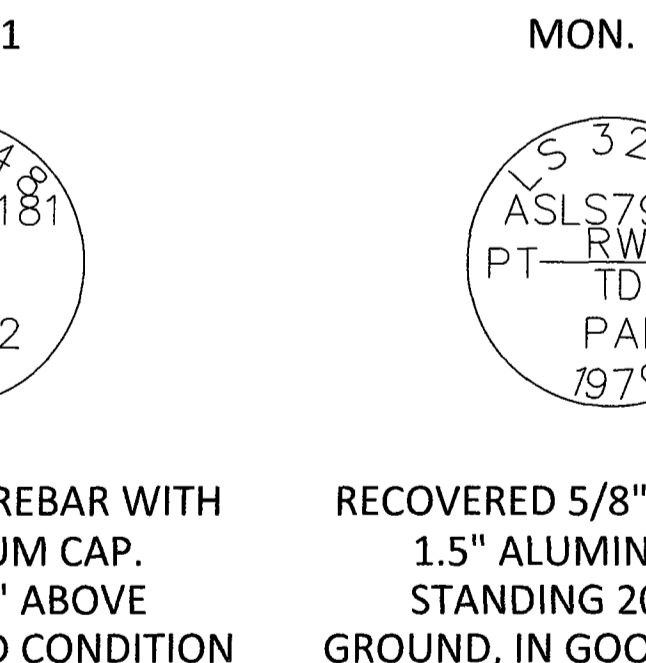

RECOVERED 5/8" REBAR WITH 1.5" ALUMINUM CAP. STANDING 15" ABOVE GROUND, IN GOOD CONDITION

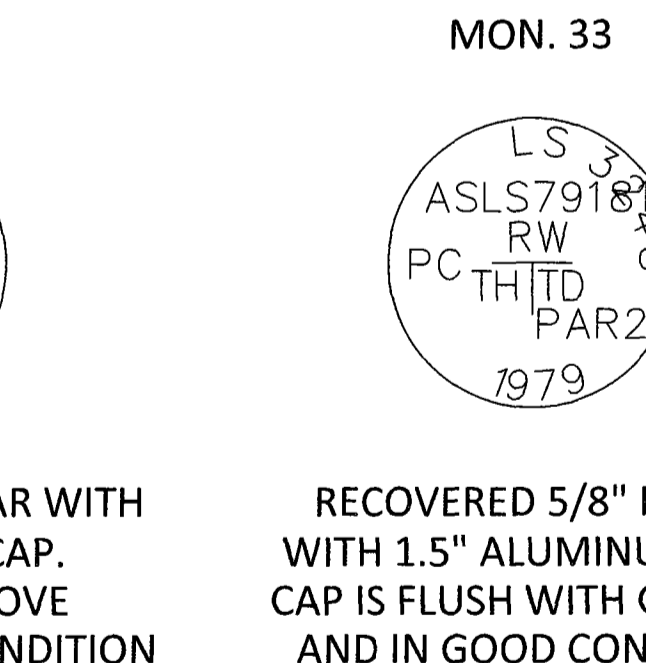

RECOVERED 5/8" REBAR WITH 1.5" ALUMINUM CAP. STANDING 20" ABOVE GROUND, IN GOOD CONDITION

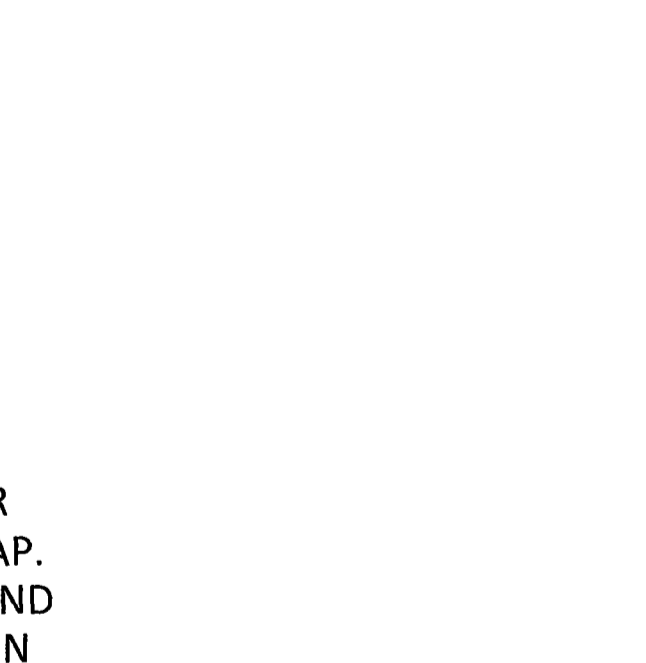

RECOVERED 5/8" REBAR WITH 1.5" ALUMINUM CAP. CAP IS FLUSH WITH GROUND AND IN GOOD CONDITION

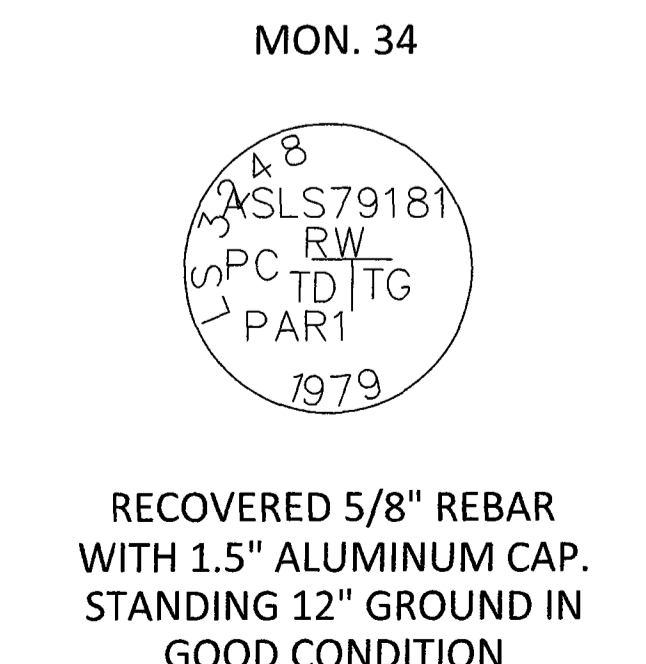

RECOVERED 5/8" REBAR WITH 1.5" ALUMINUM CAP. STANDING 12" ABOVE GROUND IN GOOD CONDITION

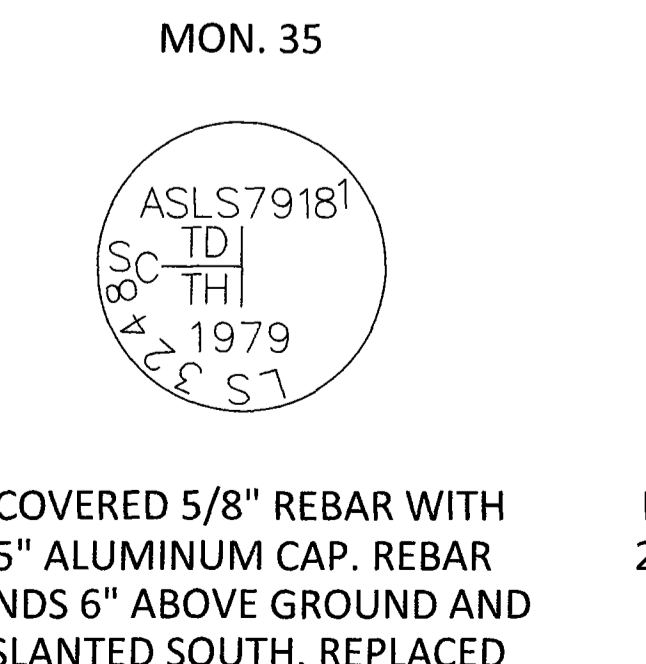

RECOVERED 5/8" REBAR WITH 1.5" ALUMINUM CAP. REBAR STANDS 6" ABOVE GROUND AND IS SLANTED SOUTH. REPLACED WITH TYPICAL SECONDARY MONUMENT THIS SURVEY

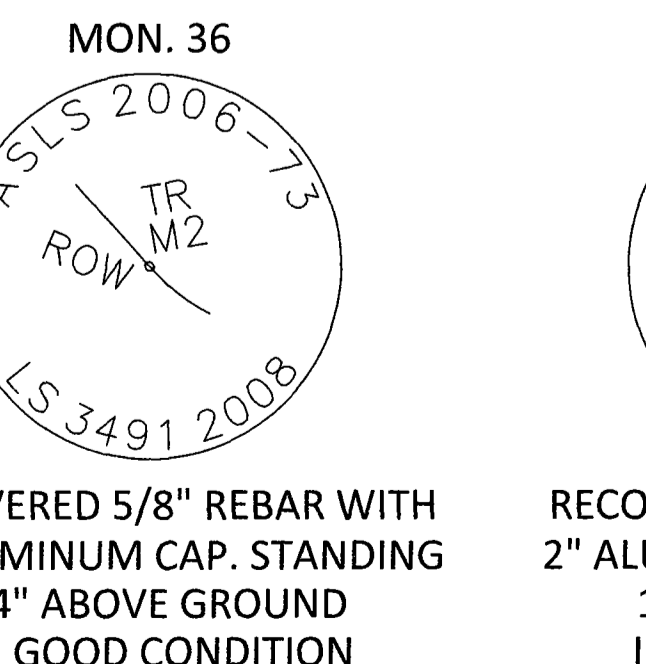

RECOVERED 5/8" REBAR WITH 2" ALUMINUM CAP. STANDING 14" ABOVE GROUND IN GOOD CONDITION

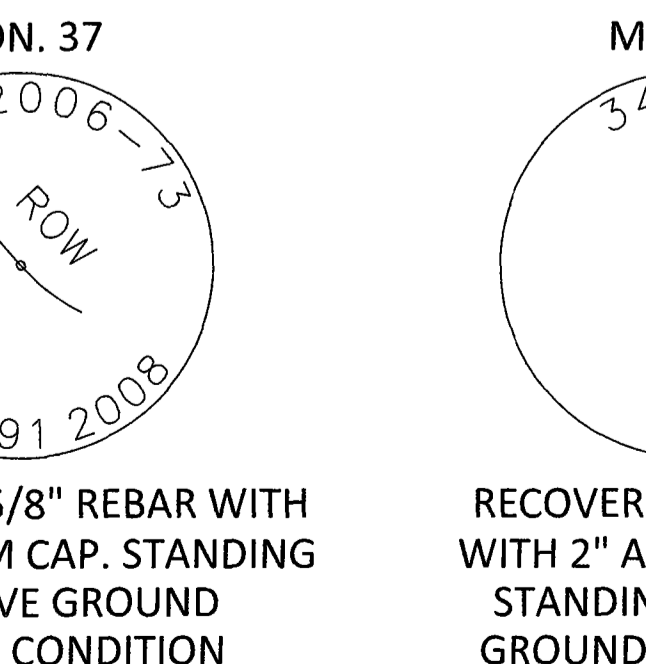

RECOVERED 5/8" REBAR WITH 2" ALUMINUM CAP. STANDING 12" ABOVE GROUND IN GOOD CONDITION

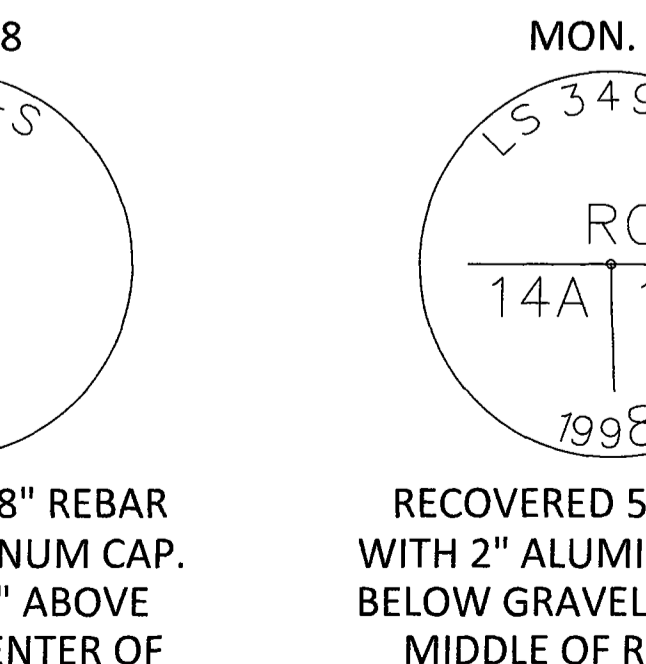

RECOVERED 5/8" REBAR WITH 2" ALUMINUM CAP. STANDING 24" ABOVE GROUND IN CENTER OF CREEK, IN GOOD CONDITION

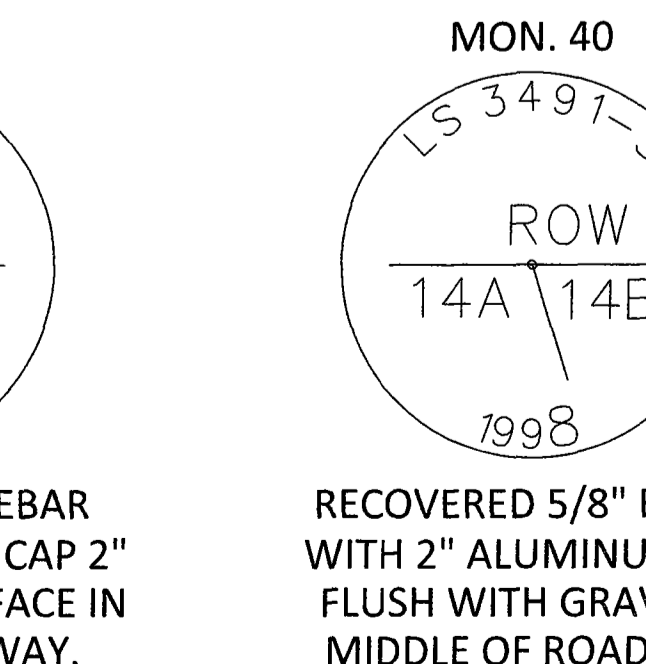

RECOVERED 5/8" REBAR WITH 2" ALUMINUM CAP 2" BELOW GRAVEL SURFACE IN MIDDLE OF ROADWAY. IN GOOD CONDITION



RECOVERED 5/8" REBAR WITH 2" ALUMINUM CAP FLUSH WITH GRAVEL IN MIDDLE OF ROADWAY. IN GOOD CONDITION



Ketchikan Recording District Plat # 2019-24

SHEET 2 OF 3

|  |   |
|--|---|
| DATE OF SURVEY: 12/05/2017   | SURVEYOR: R&M ENGINEERING-KETCHIKAN, INC. 7180 REVILLA ROAD, SUITE 300 KETCHIKAN, ALASKA 99901 PHONE # 907-225-7917 COAR# 576 |
| BEGINNING: 09/14/2018  | ENDING: 09/14/2018  |
| STATE OF ALASKA<br>DEPARTMENT OF NATURAL RESOURCES<br>DIVISION OF MINING, LAND & WATER AND<br>ALASKA MENTAL HEALTH TRUST AUTHORITY<br>ANCHORAGE, ALASKA  |   |
| <b>ALASKA STATE LAND SURVEY No. 2017-27</b>  |   |
| <i>Clark Bay View Subdivision, Phase I</i>   |   |
| A SUBDIVISION AND REPLAT OF<br>TRACT D PARCELS 1 & 2, TRACTS G & H,<br>ALASKA STATE LAND SURVEY No. 79-181 (PLAT 80-34) AND<br>TRACTS M-2 & M-3, ALASKA STATE LAND SURVEY No. 2006-73 (PLAT 2009-6)<br>AND<br>PUBLIC RIGHT-OF-WAY AND UTILITY EASEMENT VACATIONS<br>CREATING<br>LOTS 1-3, BLOCK 1; LOTS 1-10, BLOCK 2 AND TRACT A<br>CONTAINING 34.50 ACRES MORE OR LESS |   |
| LOCATED WITHIN<br>PARTIALLY SURVEYED SECTION 35, TOWNSHIP 73 SOUTH, RANGE 84 EAST<br>COPPER RIVER MERIDIAN, ALASKA<br>KETCHIKAN RECORDING DISTRICT   |   |
| DRAWN BY: MCH  | APPROVAL RECOMMENDED  |
| DATE: APRIL 8, 2019  | DATE: 5/22/2019   |
| SCALE: NTS   | CHECKED: CGP  |
|  | FILE NO: ASLS 20170027 // EV-3-281<br>TLS 2019-01   |

**PRIMARY MONUMENTS SET THIS SURVEY**

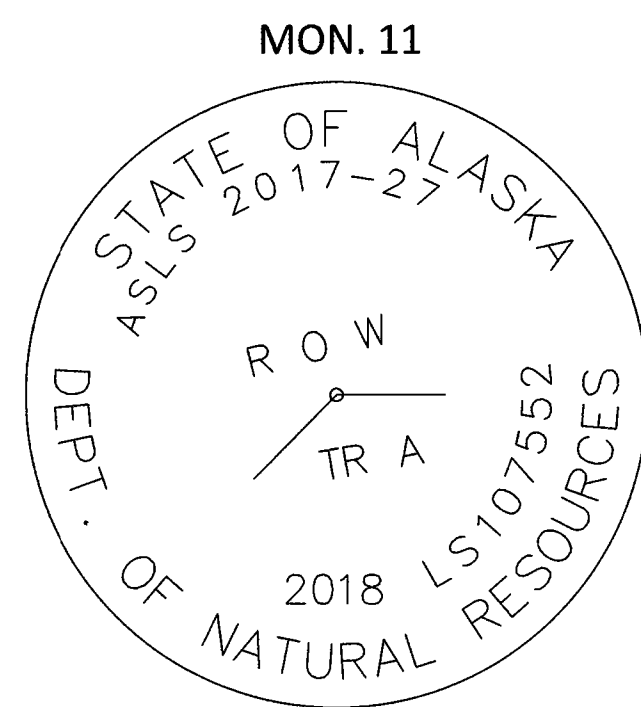

SET 2.5" DIA. X 30" ALUM POST MON. WITH 3.25" DIA. ALUM. CAP. A METALLIC GRAY COW MAGNET IS BURIED AT THE BASE OF THE MON. AND A CARSONITE WITNESS POST IS SET 1' NORTH OF MON.

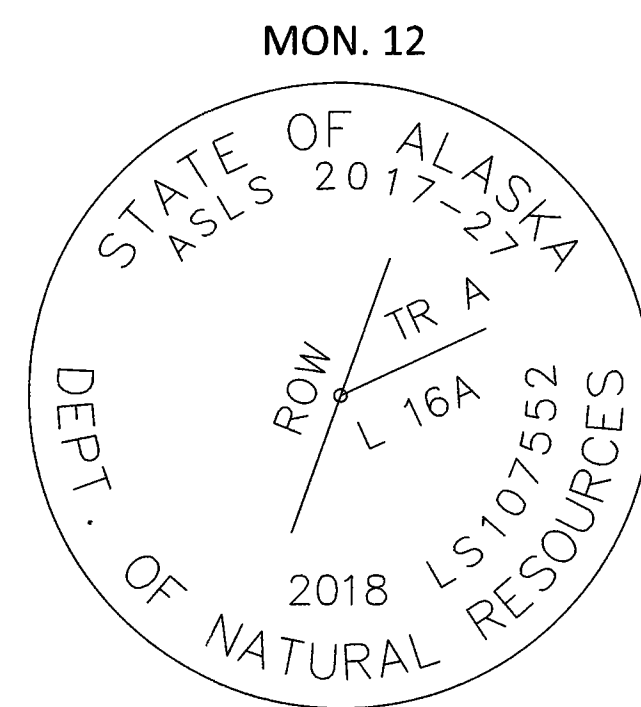

THE RECORD SECONDARY 1.5" ALUM. CAP ON 5/8" REBAR MON. WAS RECOVERED AND REPLACED WITH A 2.5" DIA. X 30" ALUM POST MON. WITH 3.25" DIA. ALUM. CAP. A METALLIC GRAY COW MAGNET IS BURIED AT THE BASE OF THE MON. AND A CARSONITE WITNESS POST IS SET 1' NORTH OF MON. THE RECORD MON. WAS BURIED UPSIDE DOWN ALONGSIDE THE PRIMARY MONUMENT.

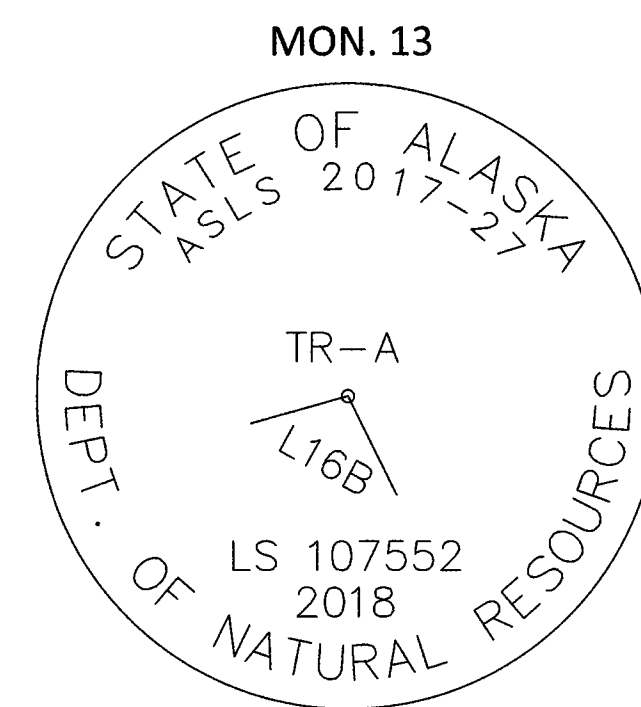

THE RECORD SECONDARY 1.5" ALUM. CAP ON 5/8" REBAR MON. WAS RECOVERED AND REPLACED WITH A 2.5" DIA. X 30" ALUM POST MON. WITH 3.25" DIA. ALUM. CAP. A METALLIC GRAY COW MAGNET IS BURIED AT THE BASE OF THE MON. AND A CARSONITE WITNESS POST IS SET 1' NORTH OF MON. THE RECORD MON. WAS BURIED UPSIDE DOWN ALONGSIDE THE PRIMARY MONUMENT.

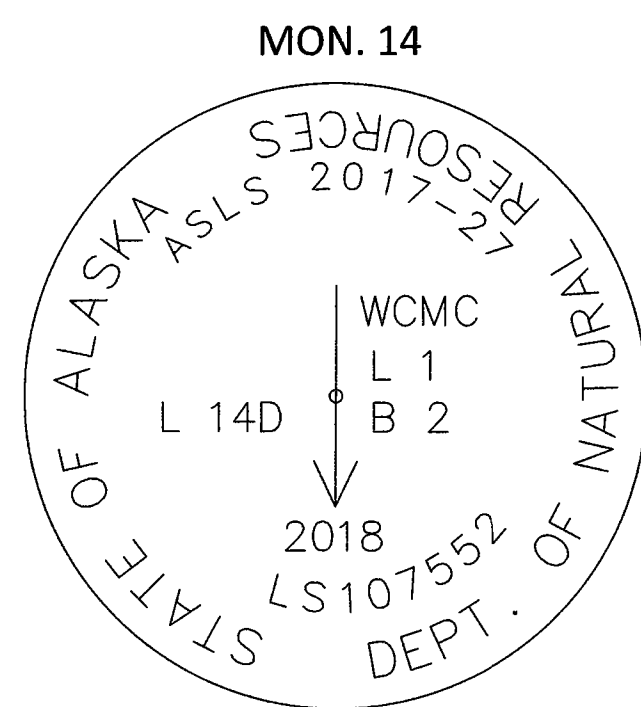

SET 2.5" DIA. X 30" ALUM POST MON. WITH 3.25" DIA. ALUM. CAP. A METALLIC GRAY COW MAGNET IS BURIED AT THE BASE OF THE MON. AND A CARSONITE WITNESS POST IS SET 1' NORTH OF MON.

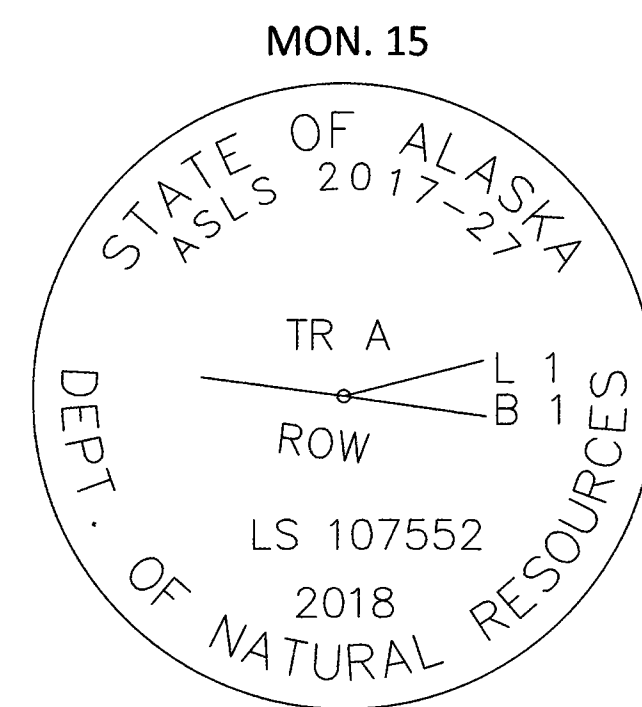

SET 2.5" DIA. X 30" ALUM POST MON. WITH 3.25" DIA. ALUM. CAP. A METALLIC GRAY COW MAGNET IS BURIED AT THE BASE OF THE MON. AND A CARSONITE WITNESS POST IS SET 1' NORTH OF MON.

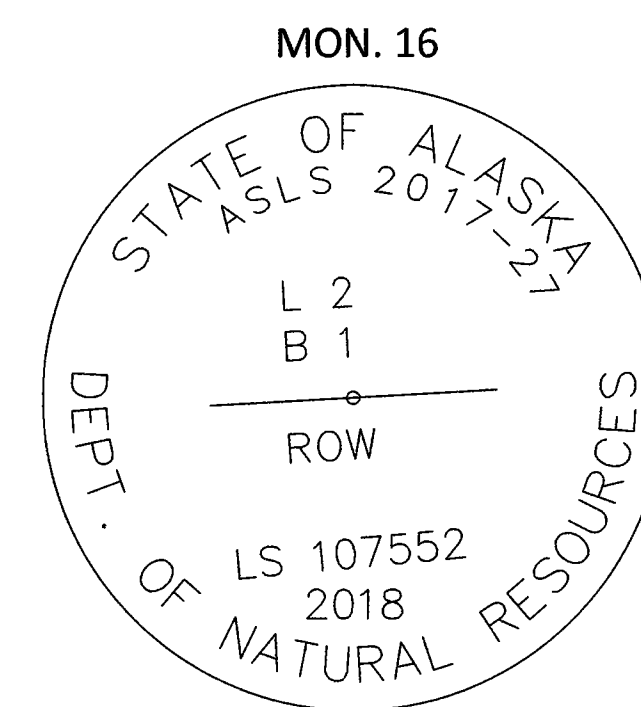

SET 2.5" DIA. X 30" ALUM POST MON. WITH 3.25" DIA. ALUM. CAP. A METALLIC GRAY COW MAGNET IS BURIED AT THE BASE OF THE MON. AND A CARSONITE WITNESS POST IS SET 1' NORTH OF MON.

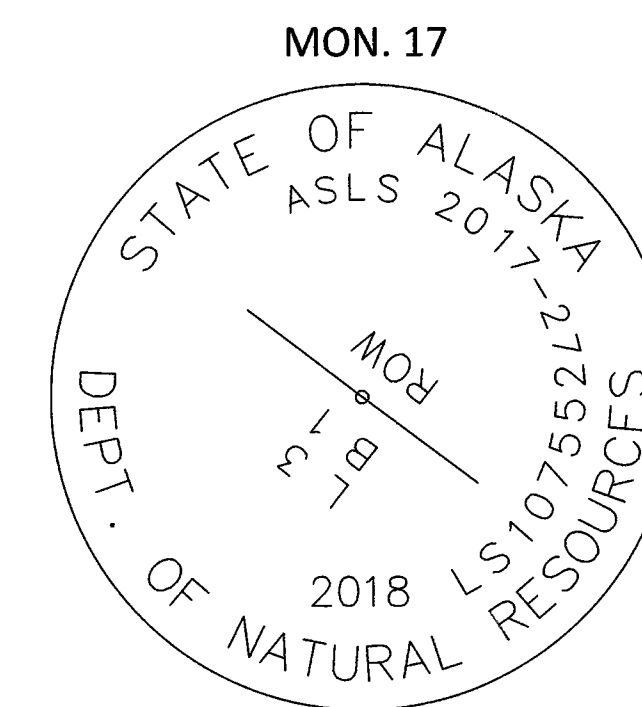

SET 2.5" DIA. X 30" ALUM POST MON. WITH 3.25" DIA. ALUM. CAP. A METALLIC GRAY COW MAGNET IS BURIED AT THE BASE OF THE MON. AND A CARSONITE WITNESS POST IS SET 1' NORTH OF MON.

**TYPICAL SECONDARY MONUMENT SET THIS SURVEY**

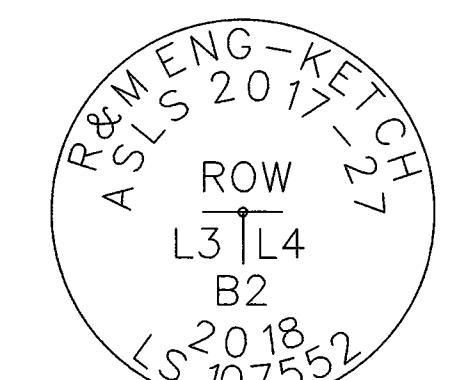

SET 5/8" X 30" LONG REBAR (UNLESS OTHERWISE NOTED) AND 2" ALUMINUM CAP WITH PLASTIC INSERT

**DETAILS:**

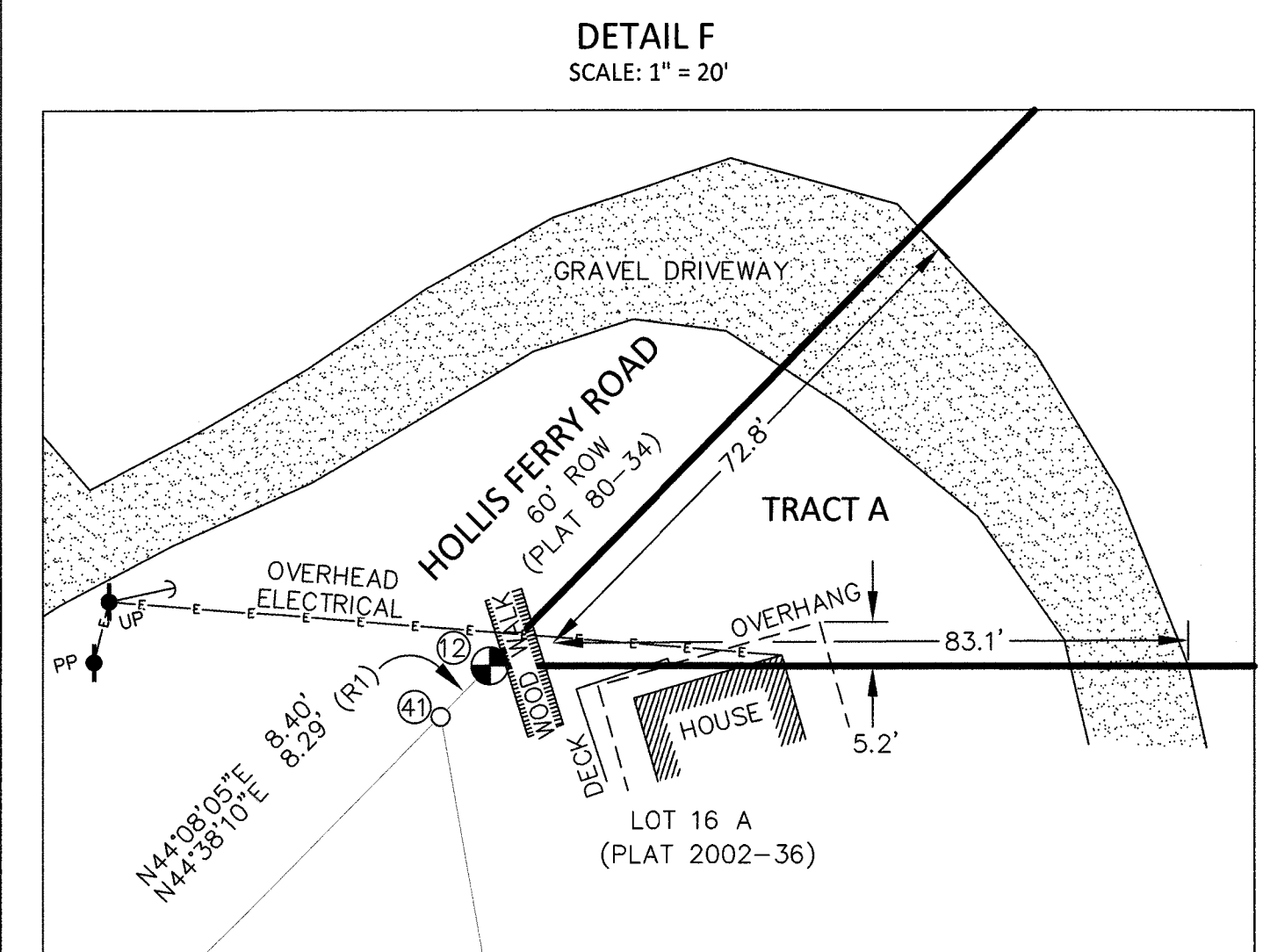
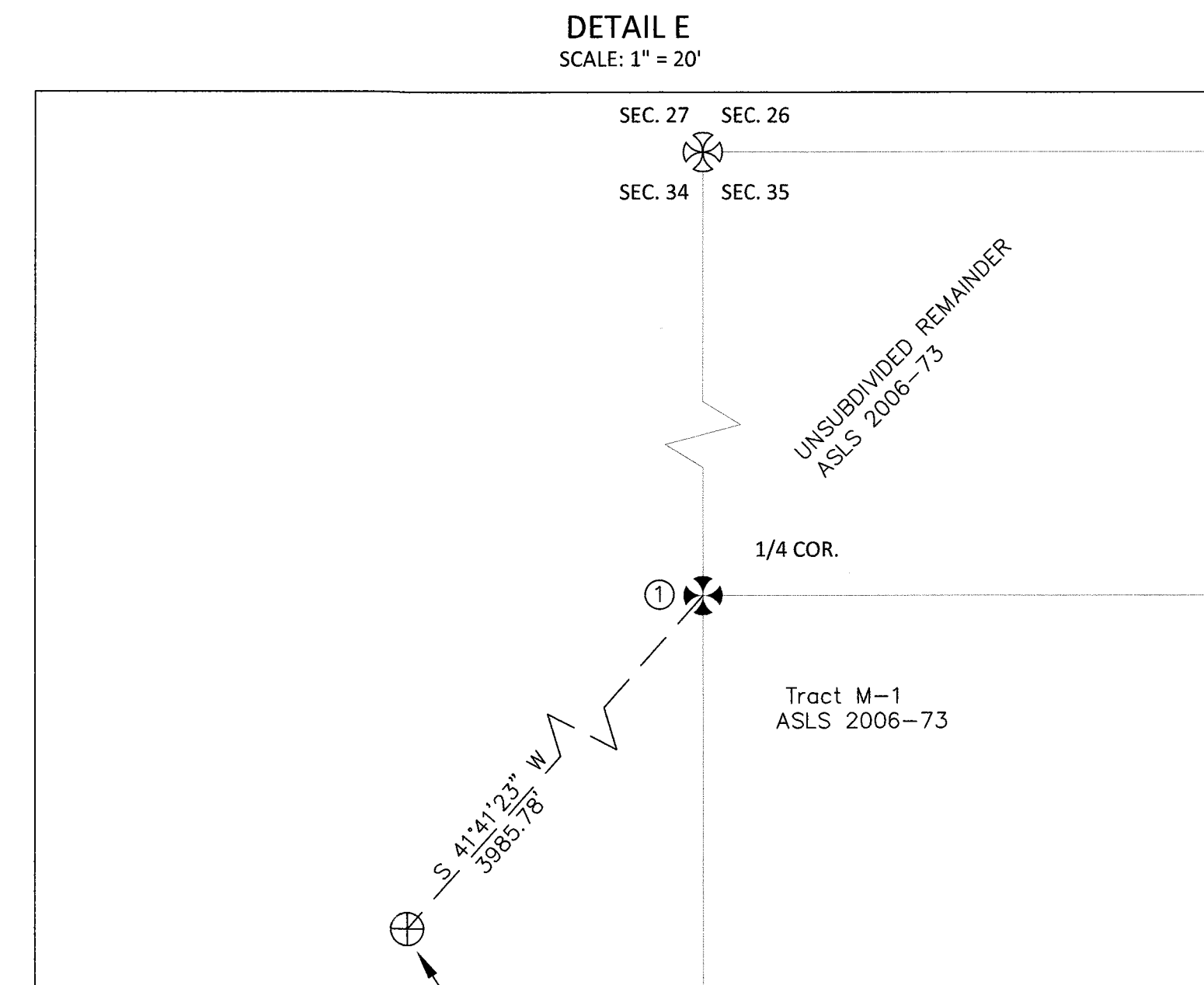
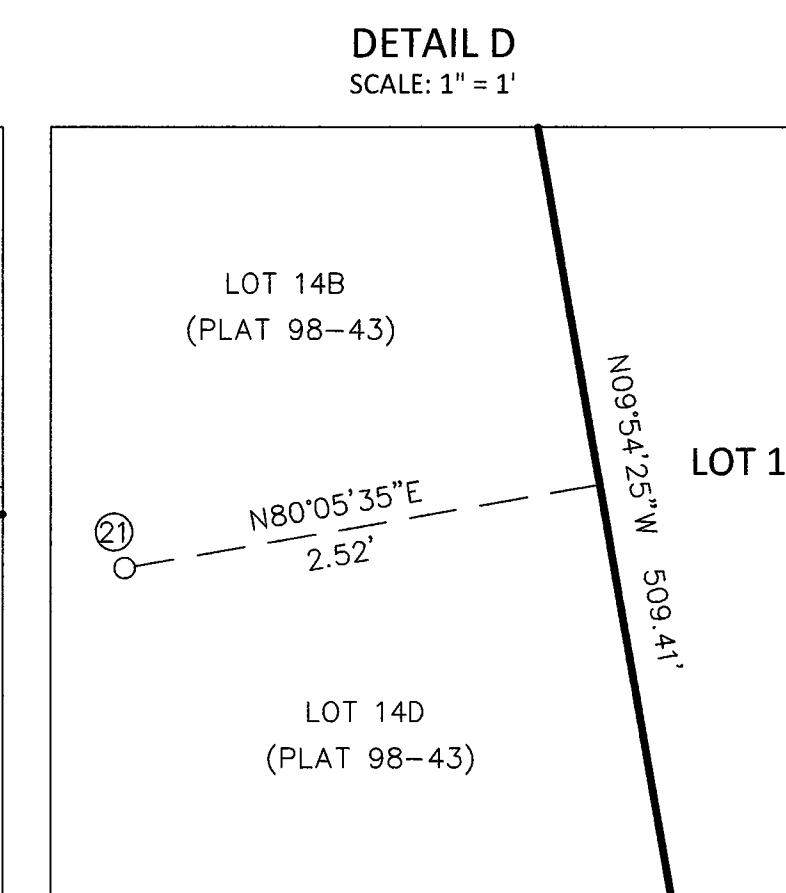
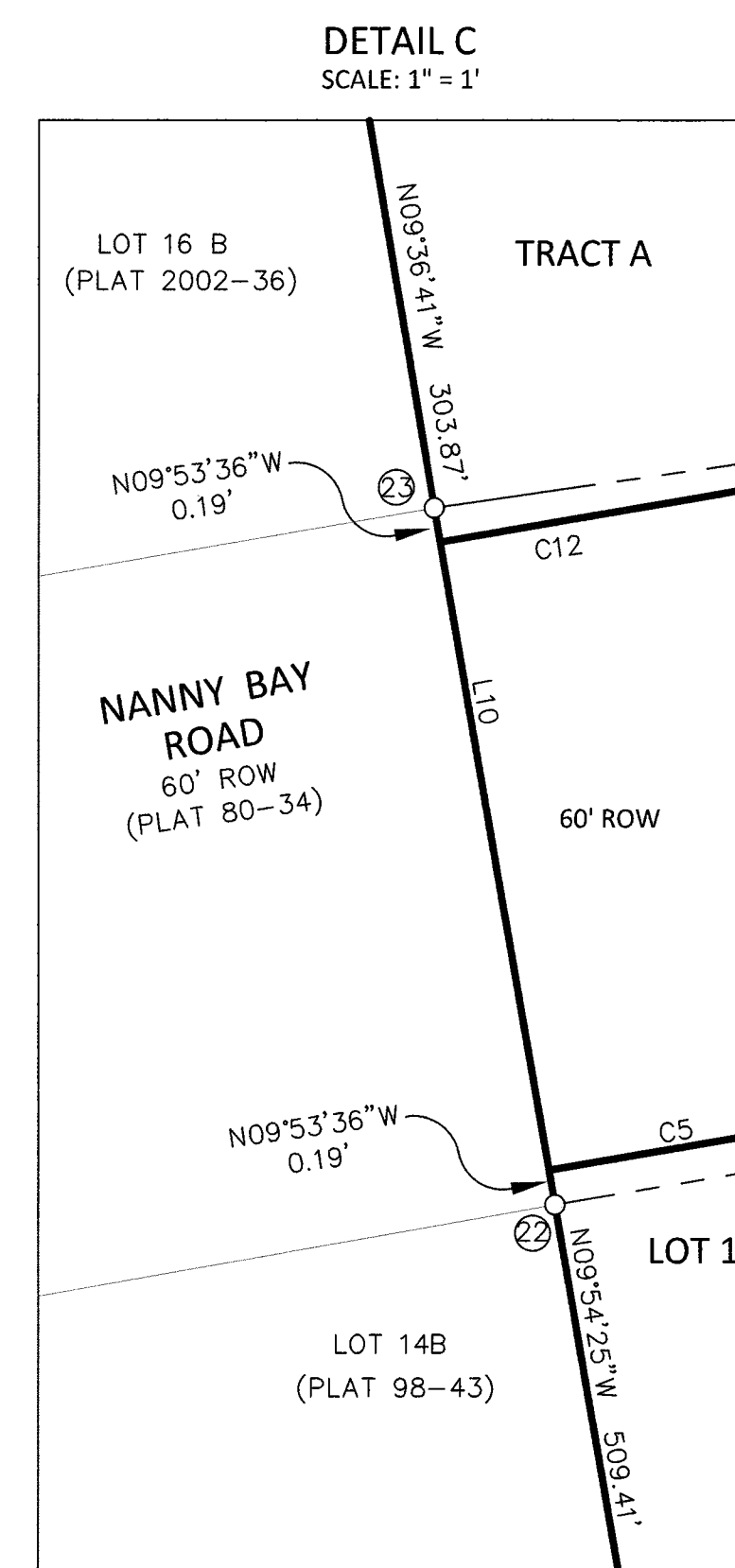
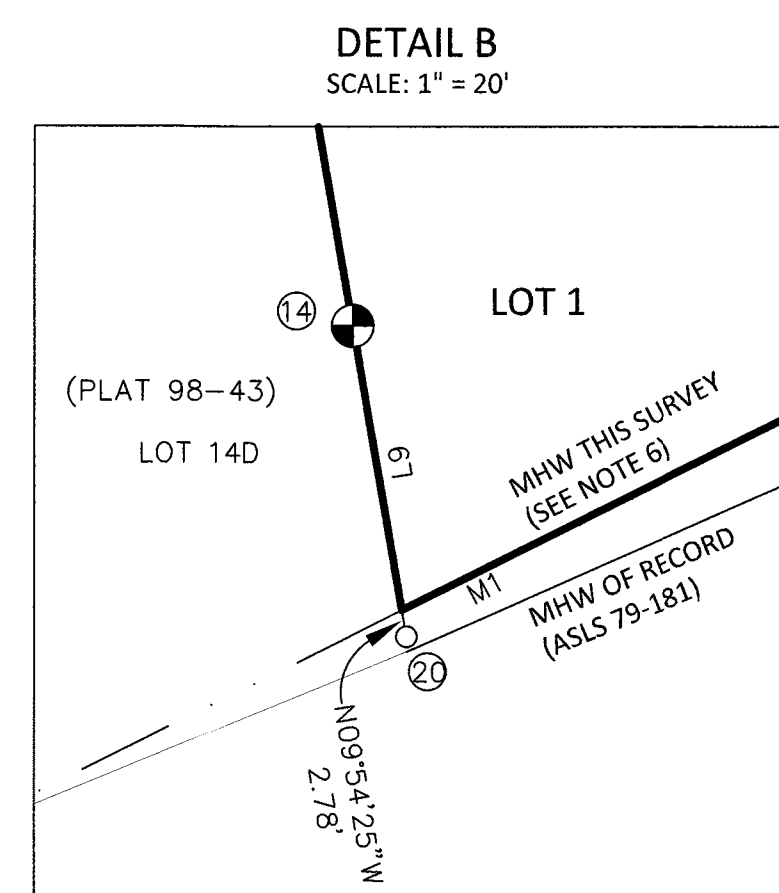
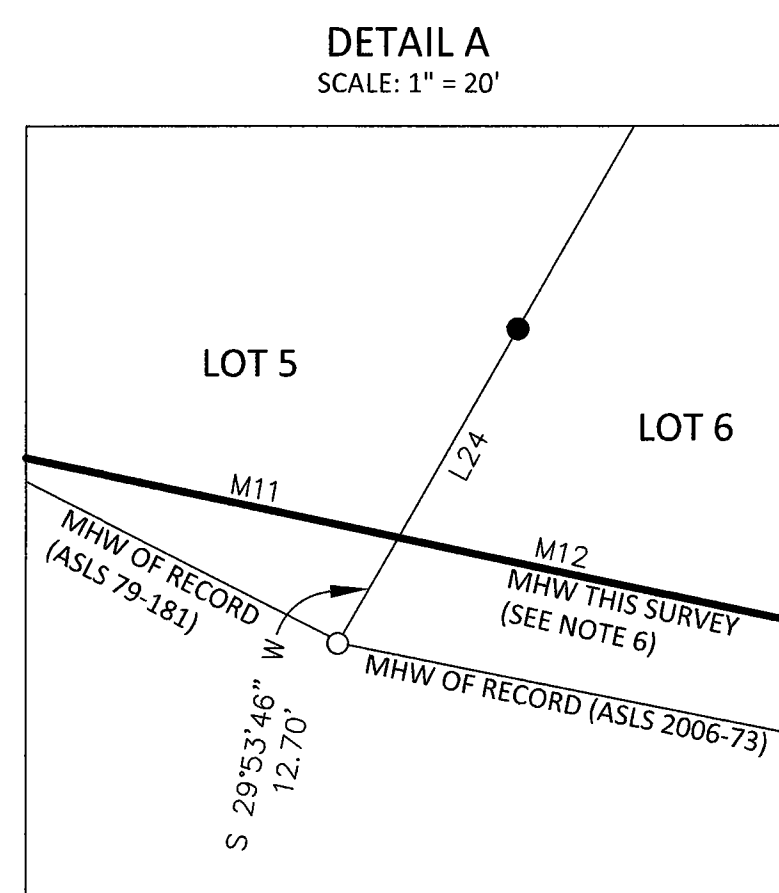

**BASIS OF COORDINATES:**  
SEE COORDINATE STATEMENT ON SHEET 1  
HCP-2  
NAD 83  
LAT. N 55°29'18.1419"  
LONG. W 132°37'41.9957"  
AK SPC 83 (ZONE 1)  
N 1336273.98 FT  
E 2901304.71 FT  
NAD 27  
LAT. N 55°29'19.4238"  
LONG. W 132°37'36.0513"  
CONVERTED FROM NAD83 TO NAD27  
USING NADCON

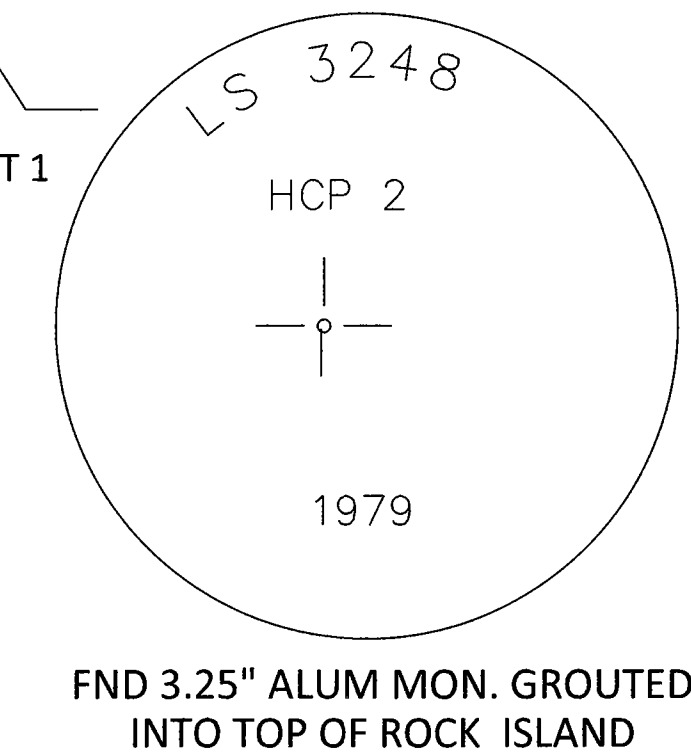

**CERTIFICATE OF OWNERSHIP AND DEDICATION**

I, WYN MENEFFEE, THE UNDERSIGNED, DO HEREBY CERTIFY THAT I AM THE EXECUTIVE DIRECTOR OF THE ALASKA MENTAL HEALTH TRUST LAND OFFICE AND AM ACTING BY AND THROUGH THE STATE OF ALASKA, DEPARTMENT OF NATURAL RESOURCES, ALASKA MENTAL HEALTH TRUST LAND OFFICE, PURSUANT TO AS 37.14.009, AS 38.05.801 AND 11 AAC 99, AS AGENT TO THE OWNER, THE ALASKA MENTAL HEALTH TRUST AUTHORITY, A PUBLIC CORPORATION WITHIN THE ALASKA DEPARTMENT OF REVENUE (AS 47.30.011 ET SEQ.).

I THE UNDERSIGNED, CERTIFY THAT THE ALASKA MENTAL HEALTH TRUST AUTHORITY IS THE OWNER OF LOTS 1-3 BLOCK 1 AND LOTS 1-5 BLOCK 2 OF ASLS 2017-27 AND TLS 2019-01, AS SHOWN HEREON. ON BEHALF OF THE ALASKA MENTAL HEALTH TRUST AUTHORITY I APPROVE THIS SURVEY AND PLAT AND DEDICATE FOR PUBLIC OR PRIVATE USE AS NOTED, ALL EASEMENTS, PUBLIC UTILITY AREAS, AND RIGHTS-OF-WAY AS SHOWN AND DESCRIBED HEREON.

5/23/19  
DATE  
WYN MENEFFEE  
EXECUTIVE DIRECTOR  
ALASKA MENTAL HEALTH TRUST LAND OFFICE  
2600 CORDOVA STREET, SUITE 100  
ANCHORAGE, ALASKA 99503

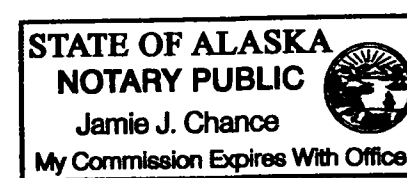

**NOTARY'S ACKNOWLEDGEMENT**

SUBSCRIBED AND SWORN TO BEFORE ME THIS 23<sup>rd</sup> DAY OF May, 2019.  
BY: Jamie J. Chance  
NOTARY PUBLIC FOR ALASKA  
MY COMMISSION EXPIRES WITH OFFICE

**CERTIFICATE OF OWNERSHIP AND DEDICATION**

I, THE UNDERSIGNED, HEREBY CERTIFY THAT I AM THE DIRECTOR, DIVISION OF MINING, LAND AND WATER AND THAT THE STATE OF ALASKA IS THE OWNER OF LOTS 6-10 BLOCK 2 AND TRACT A ASLS 2017-27, AS SHOWN HEREON. I HEREBY APPROVE THIS SURVEY AND PLAT FOR THE STATE OF ALASKA, AND DEDICATE FOR PUBLIC OR PRIVATE USE AS NOTED, ALL EASEMENTS, PUBLIC UTILITY AREAS, AND RIGHTS-OF-WAY AS SHOWN AND DESCRIBED HEREON.

5/28/2019  
DATE  
Gwendolyn M. Gervelis  
DIRECTOR, DIVISION OF MINING, LAND & WATER

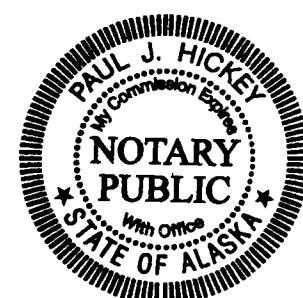

**NOTARY'S ACKNOWLEDGEMENT**

SUBSCRIBED AND SWORN TO BEFORE ME THIS 28<sup>th</sup> DAY OF May, 2019.  
BY: Gwendolyn M. Gervelis  
NOTARY PUBLIC FOR ALASKA  
MY COMMISSION EXPIRES WITH OFFICE

**PLAT APPROVAL**

THIS PLAT IS APPROVED BY THE COMMISSIONER OF THE DEPARTMENT OF NATURAL RESOURCES, OR THE COMMISSIONER'S DESIGNEE, IN ACCORDANCE WITH AS 40.15.

5/28/2019  
DATE  
Gwendolyn M. Gervelis  
COMMISSIONER

BY APPROVAL OF THIS PLAT, THE COMMISSIONER OF THE DEPARTMENT OF NATURAL RESOURCES HEREBY ACCEPTS FOR PUBLIC USE AND PUBLIC PURPOSES THE REAL PROPERTY DEDICATED TO THE PUBLIC HEREON, INCLUDING EASEMENTS, RIGHTS-OF-WAY, ALLEYS, AND ROADWAYS. THE ACCEPTANCE OF SUCH DEDICATED AREAS FOR PUBLIC USE AND PUBLIC PURPOSES DOES NOT OBLIGATE THE DEPARTMENT, ANY GOVERNING BODY, OR THE PUBLIC TO CONSTRUCT, OPERATE, MAINTAIN, OR MANAGE IMPROVEMENTS.

**TAX CERTIFICATE**

THIS SUBDIVISION IS NOT SUBJECT TO TAXATION AT THE TIME OF FILING.

**SURVEYOR'S CERTIFICATE**

I HEREBY CERTIFY THAT I AM PROPERLY REGISTERED AND LICENSED TO PRACTICE LAND SURVEYING IN THE STATE OF ALASKA, THAT THIS PLAT REPRESENTS A SURVEY MADE BY ME OR UNDER MY DIRECT SUPERVISION, THAT THE MONUMENTS SHOWN HEREON ACTUALLY EXIST AS DESCRIBED, AND THAT ALL DIMENSIONS AND OTHER DETAILS ARE CORRECT.

5/14/19  
DATE  
Christopher G. Piburn  
CHRISTOPHER G. PIBURN, PLS # 107552



**SHEET 3 OF 3**

|  |   |
|--|---|
| DATE OF SURVEY:<br>BEGINNING: 12/05/2017<br>ENDING: 09/14/2018 | SURVEYOR:<br>R&M ENGINEERING-KETCHIKAN, INC.<br>7180 REVILLA ROAD, SUITE 300<br>KETCHIKAN, ALASKA 99901<br>PHONE # 907-225-7917 CO# 576 |
|--|---|

STATE OF ALASKA  
DEPARTMENT OF NATURAL RESOURCES  
DIVISION OF MINING, LAND & WATER AND  
ALASKA MENTAL HEALTH TRUST AUTHORITY  
ANCHORAGE, ALASKA

**ALASKA STATE LAND SURVEY No. 2017-27**

**Clark Bay View Subdivision, Phase I**

A SUBDIVISION AND REPLAT OF  
TRACT D PARCELS 1 & 2, TRACTS G & H,  
ALASKA STATE LAND SURVEY No. 79-181 (PLAT 80-34) AND  
TRACTS M-2 & M-3, ALASKA STATE LAND SURVEY No. 2006-73 (PLAT 2009-6)  
AND  
PUBLIC RIGHT-OF-WAY AND UTILITY EASEMENT VACATIONS  
CREATING  
LOTS 1-3, BLOCK 1; LOTS 1-10, BLOCK 2 AND TRACT A  
CONTAINING 34.50 ACRES MORE OR LESS

LOCATED WITHIN  
PARTIALLY SURVEYED SECTION 35, TOWNSHIP 73 SOUTH, RANGE 84 EAST  
COPPER RIVER MERIDIAN, ALASKA  
KETCHIKAN RECORDING DISTRICT

|                                      |   |
|--------------------------------------|---|
| DRAWN BY: MCH<br>DATE: APRIL 8, 2019 | APPROVAL RECOMMENDED<br>DATE: Paul G. Harkin 5/22/2019<br>STATEWIDE PLATTING SUPERVISOR |
| SCALE: NTS                           | CHECKED: CGP<br>FILE NO: ASLS 20170027 // EV-3-281<br>TLS 2019-01                       |

**STATE OF ALASKA  
DEPARTMENT OF NATURAL RESOURCES  
DIVISION OF MINING, LAND AND WATER  
SURVEY SECTION**

STATE PLATTING RESOLUTION No. 2018-04

**RESOLUTION APPROVING:** The petition, **EV-3-281**, associated with ASLS 2017-27, to vacate a portion of the 60' wide Nanny Bay Road right-of-way and 20' public utility easement (PUE) adjoining or within, as applicable, Tract D Parcel 1, Tract D Parcel 2, and Tracts G & H of Alaska State Land Survey No. 79-181 (Plat 80-34) and Tracts M-2 and M-3 of Alaska State Land Survey No. 2006-73 (Plat 2009-6); relocating said ROW and PUE to the more constructible location; eliminating record boundary lines; and replatting said parcels to facilitate the proposed ASLS.

This vacation/replat action is located within Section 35, Township 73 South, Range 84 East, Copper River Meridian.

**WHEREAS**, A PETITION WAS RECEIVED FROM: Mental Health Trust Land Office and DNR, DML&W, owners of the subject lands; and,

**WHEREAS**, the proposed action is located within the Unorganized Borough. Pursuant to AS 40.15.070 the Department of Natural Resources is the platting authority; and,

**WHEREAS**, the public was given notice, a public hearing was held and comments received were considered; and,

**WHEREAS**, a Final Decision for EV-3-281, giving contingent approval to the proposed action, was approved on October 9, 2018; and,

**WHEREAS**, summary of agency and public comments are outlined in the Department of Natural Resources Final Decision EV-3-281; and,

**WHEREAS**, approval of the petition will allow the vacation and replat actions as noted above.

**NOW, THEREFORE, BE IT RESOLVED** that the State of Alaska, Department of Natural Resources approves the petition as stated above contingent upon complying with the following survey instructions:

1. Comply with conditions of approval listed in the Final Decision approved October 9, 2018.
2. Filing of a survey plat in accordance with the provisions of AS 40.15.300 through .380 and 11 AAC 53.600 through .740.
3. Submittal of a current certificate to plat in accordance with the provisions of 11 AAC 53.620.

**APPROVED** by the State of Alaska, Division of Mining, Land and Water this 15<sup>th</sup> day of October, 2018.

Gwen Gervelis, PLS  
Chief, Survey Section for  
Brent Goodrum, Director  
Division of Mining, Land & Water

NOTARY'S ACKNOWLEDGMENT

Subscribed and sworn to before me this 15<sup>th</sup> day of OCTOBER, 2018.

By: GWEN GERVELIS

Notary for the State of Alaska  
My Commission Expires: W/OFFICE

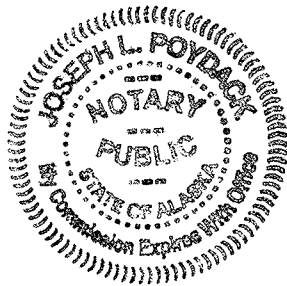

This resolution becomes valid when it is approved by the Division of Mining, Land & Water, and recorded with a plat of survey. The platting shall conform to special survey and platting requirements as deemed necessary by the State of Alaska, Division of Mining, Land and Water at the petitioner's expense. **If the provisions of the Resolution are not completed within 18 months, this Resolution becomes null and void unless extended in accordance with 11 AAC 05.240(d)(1)(F)(v).**