

MEANDER LINES

LINE	BEARING	DISTANCE
L1	S02°13'47"W	32.31'
L2	S21°43'39"E	136.33'
L3	S30°57'55"E	48.05'
L4	S11°43'08"E	42.37'
L5	S25°22'55"E	74.45'
L6	S29°47'04"E	48.56'
L7	S10°39'34"E	22.04'
L8	S30°52'19"E	16.61'
L9	S88°37'13"E	21.16'
L10	N20°14'54"E	36.90'
L11	N28°27'34"E	46.66'
L12	N26°36'54"E	45.18'
L13	N00°19'24"E	73.57'
L14	N14°38'24"W	40.55'
L15	N08°42'28"E	63.75'

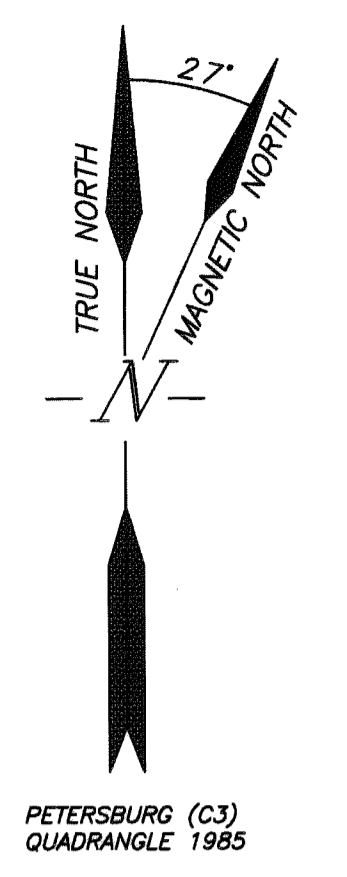

- GENERAL NOTES**
1. THE BASIS OF BEARING UTILIZED TO CONDUCT THIS SURVEY WAS BETWEEN THE BRASS STEM CAP IN CONCRETE TABLET AT THE SOUTH 1/4 CORNER OF SECTION 11 AND THE GLO BRASS CAP MONUMENT AT THE SOUTHEAST CORNER OF SECTION 11. THE ACCEPTED BEARING IS EAST.
  2. THE ERROR OF CLOSURE OF THIS SURVEY DOES NOT EXCEED 1:10,000.
  3. ALL BEARINGS SHOWN ARE TRUE BEARINGS AND ARE ORIENTED TO THE BASIS-OF-BEARING AND DISTANCES SHOWN ARE REDUCED TO HORIZONTAL FIELD DISTANCES.
  4. THE NATURAL MEANDERS OF THE MEAN HIGH WATER TIDE LINE AND THE ORDINARY HIGH WATER STREAM BED LINE FORM THE TRUE BOUNDS OF THE FALLS CREEK FISH LADDER SUBDIVISION. THE APPROXIMATE LINE OF MEAN HIGH WATER AND ORDINARY HIGH WATER, AS SHOWN IS FOR AREA COMPUTATIONS ONLY. THE TRUE FALLS CREEK FISH LADDER SUBDIVISION CORNERS BEING ON THE EXTENSION OF THE SIDELINES AND THEIR INTERSECTION WITH THE NATURAL MEANDERS.
  5. DATUM FOR THIS SURVEY: MEAN LOWER LOW WATER = 0.00 FEET.
  6. THE PROJECT BENCHMARK FOR THIS SURVEY IS U.S. COAST & GEODETIC SURVEY TIDAL BENCH MARK No. 3, A COPPER BOLT SET WITH LEAD IN A GRANITE BOULDER ON FINGER POINT. ELEVATION = 16.15 FEET (MLLW).
  7. THE LANDS WITHIN THIS SUBDIVISION ARE SUBJECT TO RESERVATIONS CONTAINED WITHIN PATENT No. 1233083.

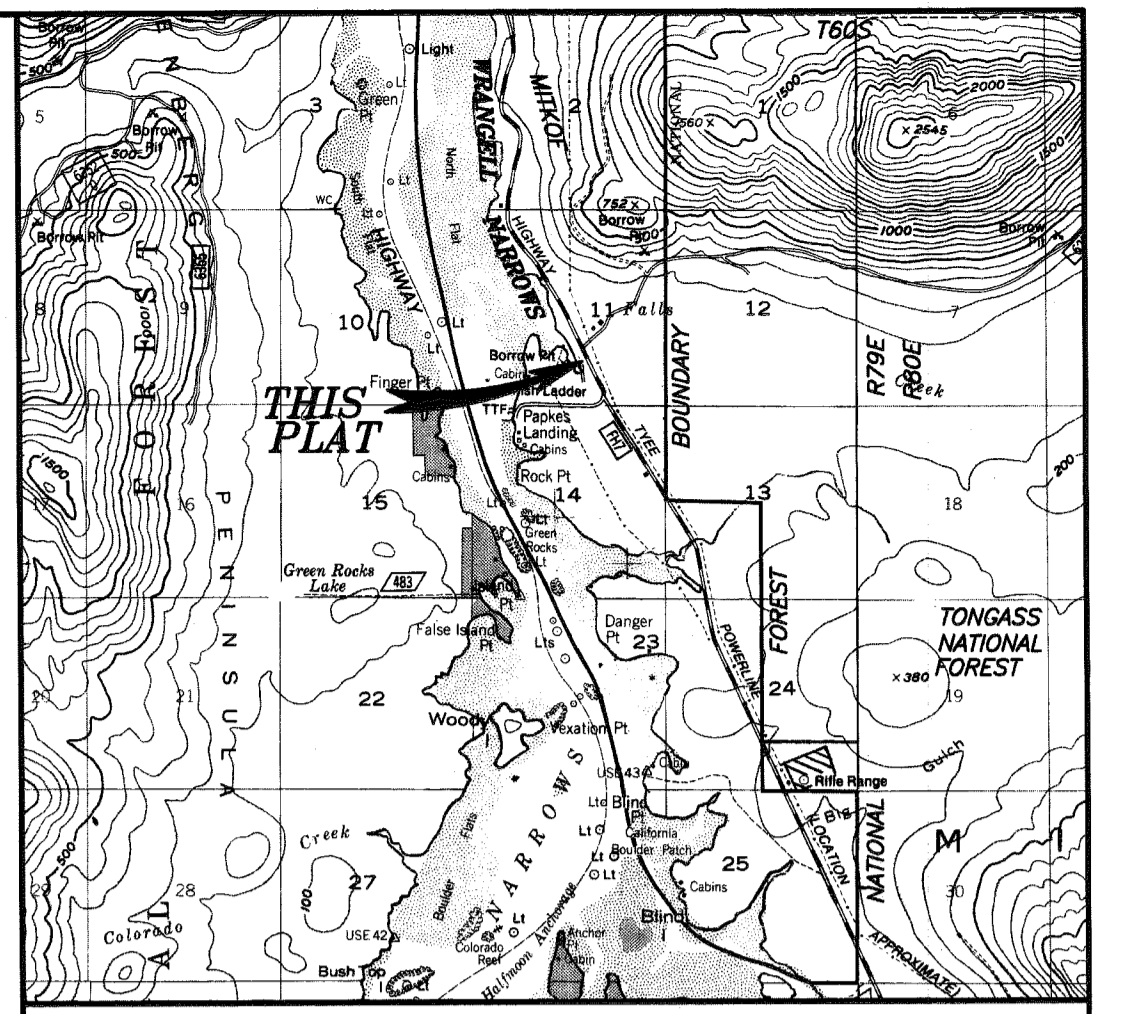

**VICINITY MAP**  
 SOURCE: USGS QUADRANGLE PETERSBURG (C-3)  
 DATE: 1953 (REV 1972) SCALE: 1 INCH = 1 MILE

**SURVEYOR'S CERTIFICATE**  
 I HEREBY CERTIFY THAT I AM PROPERLY REGISTERED AND LICENSED TO PRACTICE LAND SURVEYING IN THE STATE OF ALASKA, THAT THIS PLAT REPRESENTS A SURVEY MADE BY ME OR UNDER MY DIRECT SUPERVISION, THAT THE MONUMENTS SHOWN HEREON ACTUALLY EXIST AS DESCRIBED, AND THAT ALL DIMENSIONS AND OTHER DETAILS ARE CORRECT.  
 DATE DEC. 29, 2009 REGISTRATION NUMBER LS 5485  
 RICK G. BRAUN  
 REGISTERED LAND SURVEYOR



**TYPICAL SECONDARY MONUMENT SET THIS SURVEY**  
 BRAUN WC P.O. MC 23 2002 LS5485

**CERTIFICATE OF OWNERSHIP AND DEDICATION**  
 I, THE UNDERSIGNED, CERTIFY THAT THE ALASKA MENTAL HEALTH TRUST AUTHORITY IS THE OWNER OF FALLS CREEK FISH LADDER SUBDIVISION, AS SHOWN ON THIS PLAT. I APPROVE THIS SURVEY AND PLAT AND DEDICATE OR RESERVE FOR PUBLIC OR PRIVATE USE, AS NOTED, ALL EASEMENTS, PUBLIC UTILITY AREAS, AND RIGHTS-OF-WAY AS SHOWN AND DESCRIBED ON THIS PLAT.

DATE: Feb. 8, 2010  
 ACTING EXECUTIVE DIRECTOR, MARCIE MENEFFEE  
 ALASKA MENTAL HEALTH TRUST AUTHORITY  
 3745 COMMUNITY PARK LOOP, SUITE 200  
 ANCHORAGE, ALASKA 99510

**NOTARYS ACKNOWLEDGEMENT**  
 SUBSCRIBED AND SWORN TO BEFORE ME THIS 8 DAY OF February 2010.  
 BY: Marcie Meneffee ACTING EXECUTIVE DIRECTOR

Londa Wilson  
 NOTARY PUBLIC FOR ALASKA  
 MY COMMISSION EXPIRES: with office

**TAX CERTIFICATE**  
 THIS SUBDIVISION LIES OUTSIDE OF ANY TAXING AUTHORITY, AT THE TIME OF FILING.

**PLAT APPROVAL**  
 THIS PLAT IS APPROVED BY THE COMMISSIONER OF THE DEPARTMENT OF NATURAL RESOURCES OR THE COMMISSIONER'S DESIGNEE, IN ACCORDANCE WITH A.S. 40.15.

Yard Skanning Feb 10, 2010  
 COMMISSIONER DATE  
 BY APPROVAL OF THIS PLAT, THE COMMISSIONER OF THE DEPARTMENT OF NATURAL RESOURCES HEREBY ACCEPTS FOR PUBLIC USES AND FOR PUBLIC PURPOSES THE REAL PROPERTY DEDICATED TO THE PUBLIC BY THIS PLAT INCLUDING EASEMENTS, RIGHTS-OF-WAY, ALLEYS, AND ROADWAYS SHOWN ON THIS PLAT. THE ACCEPTANCE OF LANDS FOR PUBLIC USE OR PUBLIC PURPOSES DOES NOT OBLIGATE THE DEPARTMENT, ANY GOVERNING BODY, OR THE PUBLIC TO CONSTRUCT, OPERATE, MAINTAIN, OR MANAGE IMPROVEMENTS.

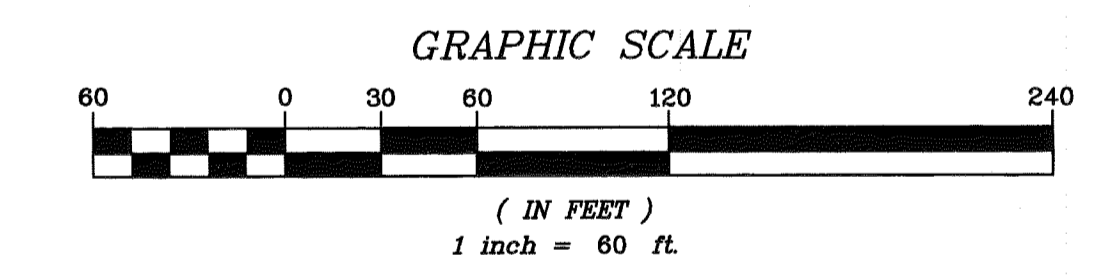

- LEGEND**
- ⊗ 2.5" DIA. GLO-BLM BRASS CAP ON IRON PIPE MONUMENT RECOVERED THIS SURVEY
  - SECONDARY MONUMENT RECOVERED THIS SURVEY 5/8" REBAR WITH 1 1/2" ALUMINUM CAP
  - SECONDARY MONUMENT RECOVERED THIS SURVEY 5/8" REBAR WITH 2" ALUMINUM CAP
  - SECONDARY MONUMENT SET THIS SURVEY - SEE DETAIL UNDER GENERAL NOTES - 5/8" x 36" REBAR WITH 2" ALUMINUM CAP
  - ⊕ 3.25" DIA. ADOT&F ALUMINUM CAP ON REBAR HIGHWAY CONTROL MONUMENT RECOVERED THIS SURVEY
  - 6"x6" YELLOW PAINTED CONCRETE HIGHWAY MONUMENT RECOVERED THIS SURVEY
  - ⊕ PRIMARY MONUMENT RECOVERED THIS SURVEY SEE NOTE BESIDE MONUMENT MARKING DRAWING
  - MHW MEAN HIGH WATER
  - OHW ORDINARY HIGH WATER
  - UNSURVEYED
  - SURVEYED

2010-2  
 Petersburg REC DIST  
 DATE: Feb. 16 2010  
 TIME: 1:28 P.  
 Requested by: DNR  
 Address: 550 W. 7th #450  
Anchorage, AK 99501

- WHEN MEASURED COURSES (BEARINGS AND DISTANCES) DIFFER FROM RECORD COURSES, RECORD COURSES ARE SHOWN IN PARENTHESES. RECORD COURSE SOURCES ARE AS FOLLOWS:
- (R1) RECORD COURSES FROM U.S. RECTANGULAR SYSTEM SURVEY
  - (R2) RECORD COURSES FROM A.S.L.S. No. 82-193.
  - (R3) RECORD COURSES FROM FALLS CREEK SUBDIVISION, PLAT No. 2002-14
  - (R4) RECORD COURSES FROM RECORD OF SURVEY PLAT No. 2002-4
  - (R5) RECORD COURSES FROM HEIMDAHL II SUBDIVISION, PLAT No. 90-20
  - (R+M) RECORD AND MEASURED

REVISED 12/28/09 RGB  
 REVISED 11/13/09 RGB

TRUST LAND SURVEY 2009-02

A PLAT OF  
**FALLS CREEK FISH LADDER SUBDIVISION**  
 CREATING LOTS 1 AND 2

A SUBDIVISION OF A PORTION OF THE S.E. 1/4, SECTION 11, T60S, R79E, C.R.M. CONTAINING 2.92 ACRES PETERSBURG RECORDING DISTRICT

SURVEYOR: RICK G. BRAUN, L.S.  
 P.O. BOX 211  
 PETERSBURG, ALASKA 99833 907 772-3986

OWNER  
 STATE OF ALASKA  
 ALASKA MENTAL HEALTH TRUST AUTHORITY  
 3745 COMMUNITY PARK LOOP, SUITE 200  
 ANCHORAGE, ALASKA 99501

DATE OF SURVEY: JUNE 2009 DRAWN BY: R.G.B. PROJECT NO: AK10A09 SHEET NO: 1 OF 1

SCALE: 1" = 60' CHECKED BY: D.C.T. D.N.R. FILE NO. FA20090036