

# TOWNSHIP 7 NORTH, RANGE II WEST, OF THE SEWARD MERIDIAN, ALASKA

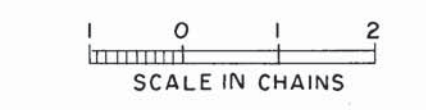

Area Surveyed, 8,332.88 Acres

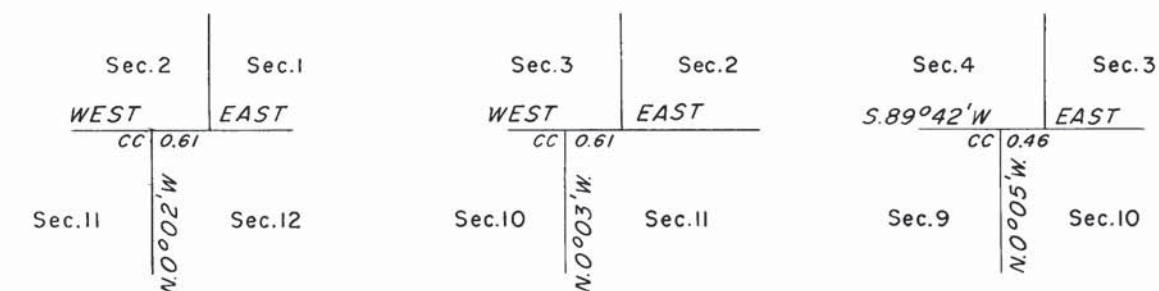

ENLARGED DIAGRAMS

This plat represents the dependent resurvey of the south boundary of sections 1 through 4, and the survey of a portion of the south and east boundaries, and subdivisional and meander lines.

Survey executed by C. Norman Brown, Cadastral Surveyor, May 26 to August 19, 1964, under Special Instructions dated May 3, 1963, and approved May 9, 1963, for Group No. 161, Alaska.

The west two miles of the north boundary were surveyed in 1922 by Fred Dahlquist. The west boundary was surveyed in 1953 by Gordon W. Webber. The west two miles of the south boundary, the east four miles of the north boundary, the north mile of the east boundary, were surveyed in 1955 by Robert Q. Pickering.

The meanders of the lakes were determined by photogrammetric methods, using photographs taken in 1964.

A portion of this township is designated Tract "A" for legal description purposes.

UNITED STATES DEPARTMENT OF THE INTERIOR  
BUREAU OF LAND MANAGEMENT  
Washington, D. C. May 12, 1966

This plat is strictly conformable to the approved field notes, and the survey, having been correctly executed in accordance with the requirements of law and the regulations of this Bureau, is hereby accepted.

For the Director

Acting Chief, Division of Engineering

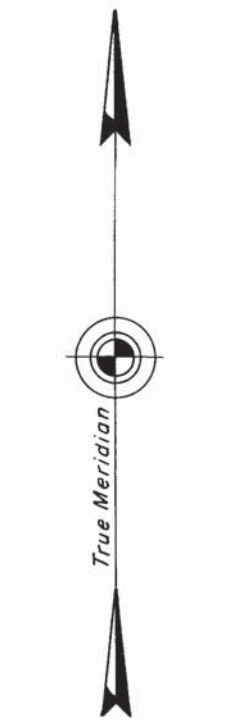
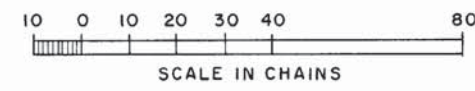

Latitude 60° 39' N.  
Longitude 151° 17' 30" W.